

Poliform

WALL SYSTEM

DAY SYSTEMS

Poliform

WALL SYSTEM DAY SYSTEM
DIGITAL CATALOGUE

Wall System è un sistema giorno che rende la libreria il centro estetico e funzionale del living. Un programma d'arredo in continua evoluzione, dall'eccezionale versatilità stilistica. Il sistema si basa sulla libreria a spalla portante, la cui struttura si alleggerisce grazie alle sottili griglie divisorie. Ante – anche scorrevoli o a ribalta – teche in vetro e schienali in finiture preziose si integrano alla classica libreria, per adattarsi a qualsiasi esigenza.

Wall System is a day system that makes the bookcase the aesthetic and functional centre of the living room. A constantly evolving furniture design with exceptional stylistic versatility. The system is based on the load-bearing bookcase, whose structure is lightened by the thin dividing grates. Doors – also sliding or flap – glass cases and back panels in precious finishes integrate with the classic bookcase, to adapt to any need.

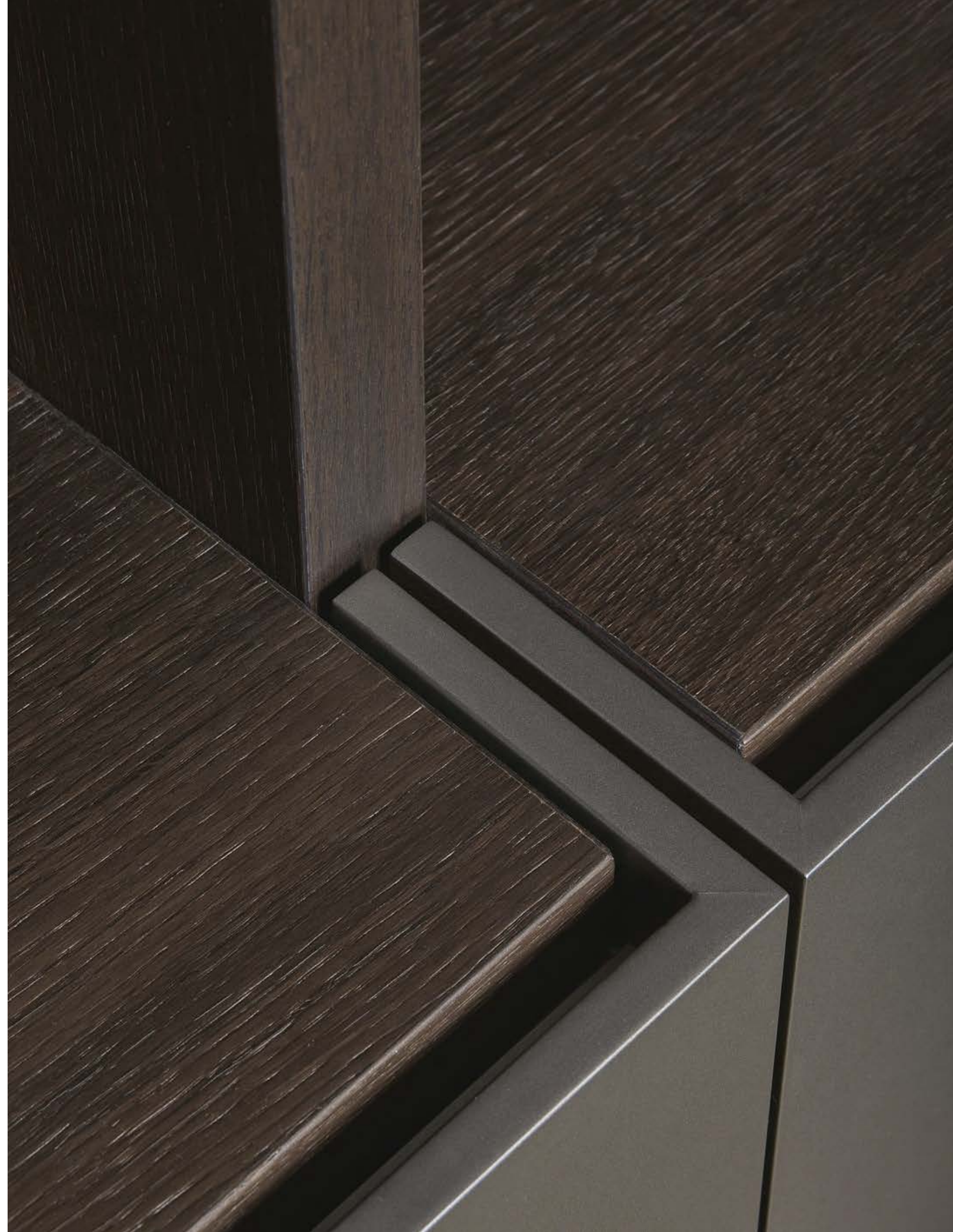

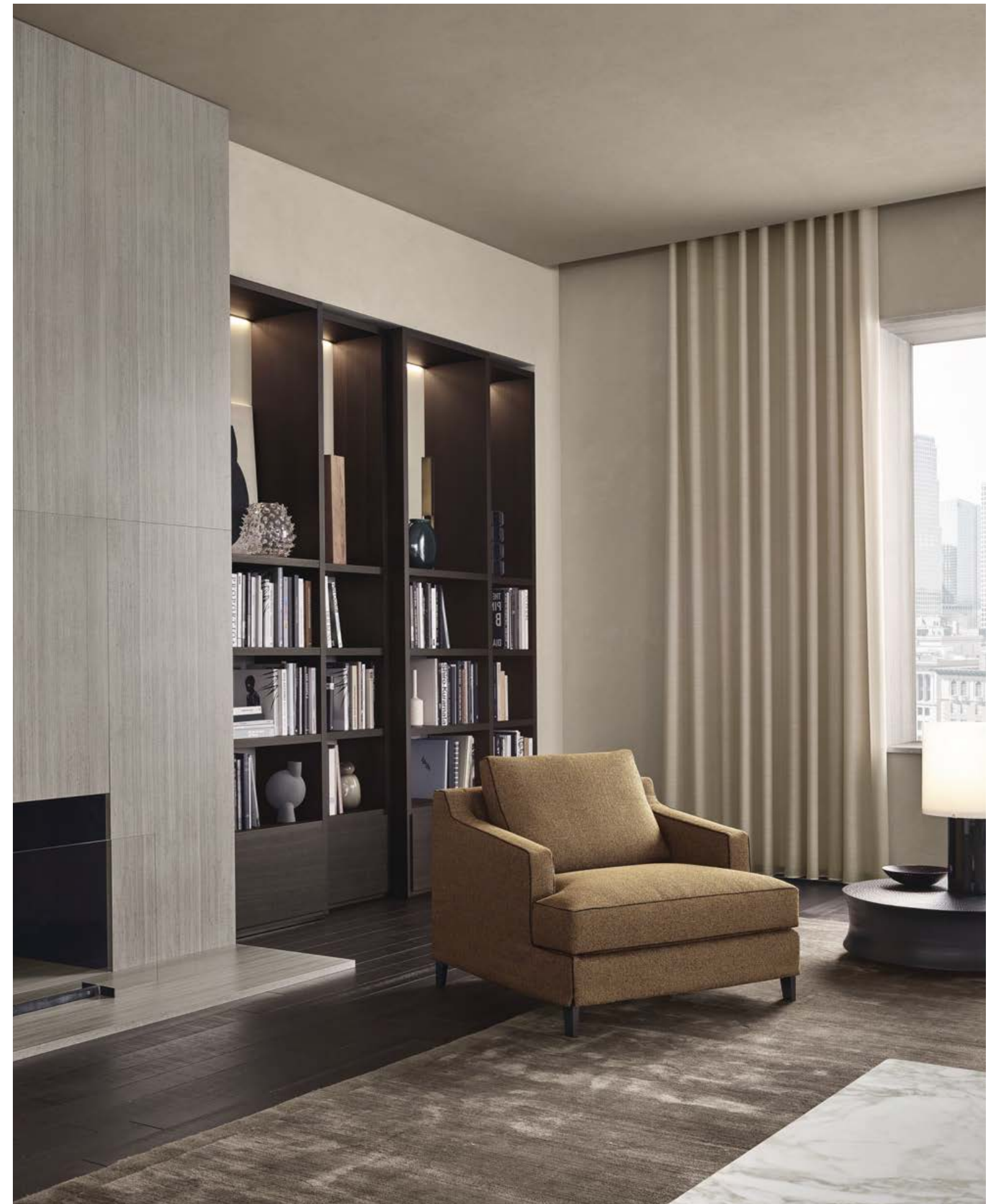





Qui, nelle pagine precedenti e nella successiva: composizione Wall System con struttura, ripiani e cassetti Slim in rovere spessart e schienali in laccato lucido canapa con luce a led integrata. Divani Bellport in tessuto sfoderabile Naxos 07 cemento, cuscini in tessuto Sendai 03 fango e piedini in champagne opaco. Poltrona Bellport con fondopiega in tessuto sfoderabile Kitami 09 senape e bordura in seta colore nero, piedini in brown nickel opaco; pouf Bellport in pelle sfoderabile Soft 13 carbone e piedini in champagne opaco. Tavolini Creek con piano in marmo calacatta oro lucido e piano inferiore in laccato lucido canapa, struttura champagne satinato. Accanto al pouf, tavolino Creek con piano in vetro fumé e piano inferiore in olmo nero, struttura brown nickel satinato. Sullo sfondo: accanto al divano, tavolino Soori in metallo finitura bronzo anticato. Tappeto Frame grey.

Here, previous pages and following page: Wall System composition with structure, shelves and Slim drawers in spessart oak and backs in glossy lacquer canapa with integrated led light. Bellport sofas in removable fabric Naxos 07 cemento, cushions in fabric Sendai 03 fango and mat champagne feet. Bellport armchair with slip cover in removable fabric Kitami 09 senape and silk border colour nero, mat brown nickel feet; Bellport pouf in removable leather Soft 13 carbone and mat champagne feet. Creek coffee tables with top in glossy marble calacatta oro and lower shelf in glossy lacquer canapa, structure satin champagne. Next to the pouf, Creek coffee table with top in fumé glass and lower shelf in black elm, mat brown nickel structure. In the background: next to the sofa, Soori coffee table in metal with antique bronze finish. Carpet Frame grey.







In questa pagina: composizione Wall System con struttura, ripiani e cassetti Slim in rovere spessart e schienali in laccato lucido canapa con luce a led integrata. Tavolino Dama in laccato lucido granata. Divano Bellport in tessuto sfoderabile Naxos 07 cemento, cuscini in tessuto Sendai 03 fango e velluto Persia 1404 carbone, piedini in champagne opaco. Accanto al divano, tavolino Creek con piano in vetro fumé e piano inferiore in olmo nero, struttura brown nickel satinato. In primo piano, tavolino Creek con piano in marmo calacatta oro lucido e piano inferiore in laccato lucido canapa, struttura champagne satinato. Tappeto Frame grey.

This page: Wall System composition with structure, shelves and Slim drawers in spessart oak and backs in glossy lacquer canapa with integrated led light. Dama coffee table in glossy lacquer granata. Bellport sofas in removable fabric Naxos 07 cemento, cushions in fabric Sendai 03 fango and velvet Persia 1404 carbone, mat champagne feet. Next to the sofa, Creek coffee table with top in fumé glass and lower shelf in black elm, mat brown nickel structure. In foreground: Creek coffee tables with top in glossy marble calacatta oro lucido and lower shelf in glossy lacquer canapa, mat champagne structure. Carpet Frame grey.



Qui e nella pagina precedente: composizione Wall System con struttura in laccato opaco canapa, schienali in laccato opaco ottone e schienali inclinati in gres porcellanato lucido calacatta oro, griglie e portale TV con mensoloni e cassetti Jet in laccato metallico ottone, luce a led integrata. Divano Mondrian in tessuto sfoderabile Kitami 11 oceano, cuscini nei tessuti Sendai 05 navy e Naxos 16 sabbia, piedini in brown nickel opaco. Poltrona Stanford esterno in cuoio 26 invecchiato e interno in pelle Soft 04 cognac, basamento girevole in brown nickel lucido. Al centro, tavolino Bristol con piano in marmo calacatta oro levigato e piano inferiore in olmo nero, inserti e piedini in brown nickel opaco. Accanto al divano, tavolino Paris Seoul in cuoio 02 nero con interno struttura in brown nickel opaco. Tappeto Plain tortora.

Here and previous page: Wall System composition with structure in mat lacquer canapa, backs in mat lacquer ottone and oblique backs in glossy gres porcelain calacatta oro, grids and TV-portal with thick shelves and Jet drawers in metal lacquer ottone, integrated led light. Mondrian sofa in removable fabric Kitami 11 oceano, cushions in fabric Sendai 05 navy and Naxos 16 sabbia, mat brown nickel feet. Stanford armchair, outer cover in hide 26 invecchiato and inner cover in leather Soft 04 cognac, swivel base in glossy brown nickel. At the centre, Bristol coffee table with top in mat marble calacatta oro and lower shelf in black elm, inlays and feet in mat brown nickel. Next to the sofa, Paris Seoul coffee table in hide 02 nero with structure interior in mat brown nickel. Carpet Plain tortora.



INTERIOR 01

Wall System A

Struttura: rovere spessart.
 Schienali: laccato lucido canapa.
 Cassetti Slim: rovere spessart.
 Luce a led.

Wall System B

Struttura: laccato opaco canapa.
 Schienali: laccato opaco ottone.
 Schienali inclinati: gres porcellanato lucido calacatta oro.
 Griglie e fianchetti: laccato metallico ottone spessore mm 14.
 Portale TV: schienali laccato opaco ottone, mensolone, basamento ed elemento Jet con cassetti laccato metallico ottone.
 Luce a led.

Wall System A

Structure: spessart oak.
 Backs: glossy lacquer canapa.
 Slim drawers: spessart oak.
 Led light.

Wall System B

Structure: mat lacquer canapa.
 Backs: mat lacquer ottone.
 Oblique backs: glossy gres porcelain calacatta oro.
 Grids and partitions: metal lacquer ottone thickness 1/2".
 TV-portal: backs mat lacquer ottone, thick shelf, base and Jet element with drawers metal lacquer ottone.
 Led light.

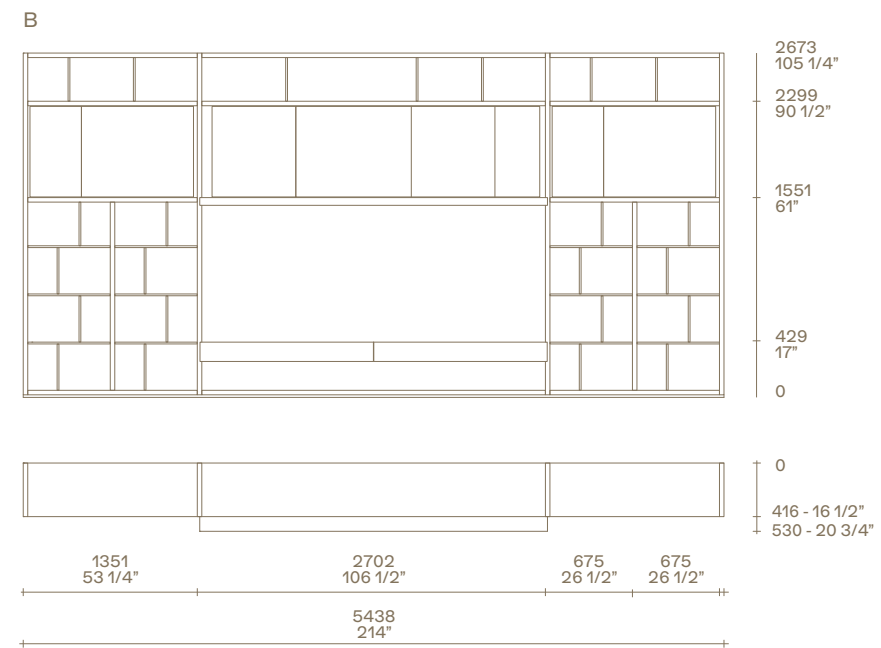
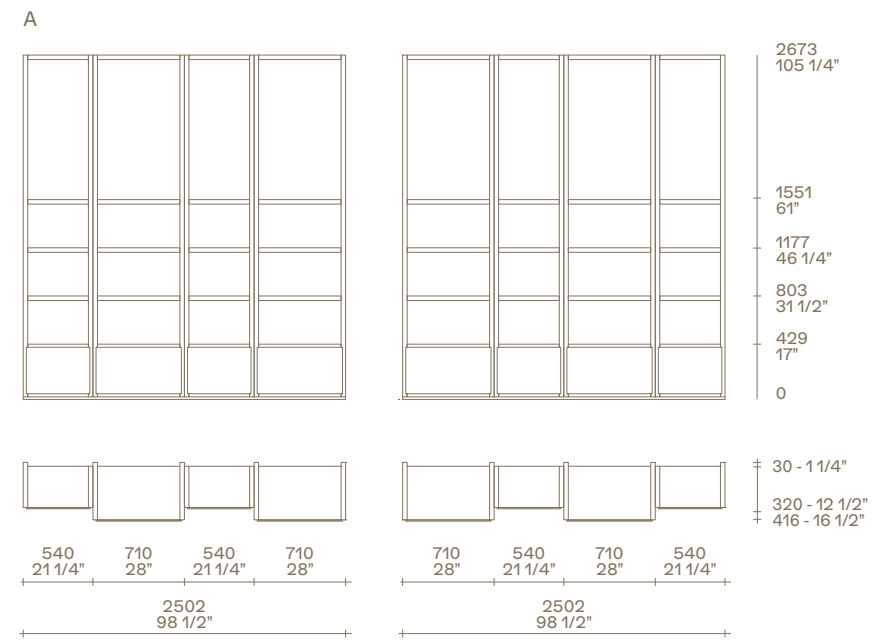





Qui e nelle pagine precedenti: composizione Wall System con struttura in laccato opaco canapa, schienali inclinati in gres porcellanato lucido noir saint laurent con luce a led integrata e in rovere spessart con fianchetti divisorii in laccato metallico titanio. Divano Sydney rivestito in tessuto sfoderabile Lima 43 écreu con cuciture sahara, cuscini in tessuto Skyros 09 oliva e piedini brown nickel lucido. Tavolini Sydney in olmo nero e marmo noir saint laurent lucido. Panca Home Hotel in olmo nero. Tavolino Dama in laccato lucido visone. Tappeto Plain natural.

Here and previous pages: Wall System composition with structure in mat lacquer canapa, oblique backs in glossy gres porcelain noir saint laurent with integrated led light and in spessart oak with partition sides in metal lacquer titanio. Sydney sofa covered in removable fabric Lima 43 écreu with stitchings sahara, cushions in fabric Skyros 09 oliva and glossy brown nickel feet. Sydney coffee tables in black elm and glossy marble noir saint laurent. Home Hotel bench in black elm and glossy marble noir saint laurent. Home Hotel bench in black elm and glossy marble noir saint laurent. Dama coffee table in glossy lacquer visone. Carpet Plain natural.





A sinistra: composizione Wall System con struttura in laccato opaco canapa, schienali inclinati in gres porcellanato lucido noir saint laurent con luce a led integrata e in rovere spessart con fianchetti divisori in laccato metallico titanio. Divano Sydney rivestito in tessuto sfoderabile Lima 43 écreu con cuciture sahara, cuscini in tessuto Skyros 09 oliva e piedini brown nickel lucido. Tavolino Sydney e panca Home Hotel in olmo nero. Tappeto Plain natural. Sotto: dettaglio degli schienali inclinati in gres porcellanato lucido noir saint laurent con luce a led integrata.

To the left: Wall System composition with structure in mat lacquer canapa, oblique backs in glossy gres porcelain noir saint laurent with integrated led light and in spessart oak with partition sides in metal lacquer titanio. Sydney sofa covered in removable fabric Lima 43 écreu with stitchings sahara, cushions in fabric Skyros 09 oliva and glossy brown nickel feet. Sydney coffee table and Home Hotel bench in black elm. Carpet Plain natural. Below: close up of the oblique backs in glossy gres porcelain noir saint laurent with integrated led light.



A destra: composizione Wall System con struttura in laccato opaco canapa, schienali e schienali inclinati in laccato metallico titanio. Portale con mensoloni in laccato opaco canapa, schienali in rovere spessart, cassetti Jet in laccato metallico titanio e piano dello scrittoio in cuoio 26 invecchiato, luce a led integrata. Panca Home Hotel in olmo nero con piano rivestito in cordatura di pelle testa di moro. Sotto: dettaglio del piano scrittoio in cuoio 26 invecchiato.

To the right: Wall System composition with structure in mat lacquer canapa, backs and oblique backs in metal lacquer titanio. Portal with thick shelves in mat lacquer canapa, backs in spessart oak, Jet drawers in metal lacquer titanio and desktop in hide 26 invecchiato, integrated led light. Home Hotel bench in black elm with seat covered in stringed leather testa di moro. Below: close up of the desktop in hide 26 invecchiato.



INTERIOR 02

Wall System A

Struttura: laccato opaco canapa.
 Schienali: rovere spessart.
 Schienali inclinati: gres porcellanato lucido noir saint laurent, luce a led.
 Fianchetti: laccato metallico titanio spessore mm 14.

Wall System B

Struttura: laccato opaco canapa.
 Schienali inclinati: laccato metallico titanio, luce a led.
 Portali: schienali rovere spessart, mensoloni laccato opaco canapa, cassetti Jet laccato metallico titanio, piano scrittoio rivestito in cuoio 26 invecchiato.
 Luce a led.

Wall System A

Structure: mat lacquer canapa.
 Backs: spessart oak.
 Oblique backs: glossy gres porcelain noir saint laurent, integrated led light.
 Partitions: metal lacquer titanio thickness 1/2".

Wall System B

Structure: mat lacquer canapa.
 Oblique backs: metal lacquer titanio, integrated led light.
 Portals: backs spessart oak, thick shelves mat lacquer canapa, Jet drawers metal lacquer titanio, desktop covered in hide 26 invecchiato.
 Led light.

Wall System

Design R&D Poliform

A

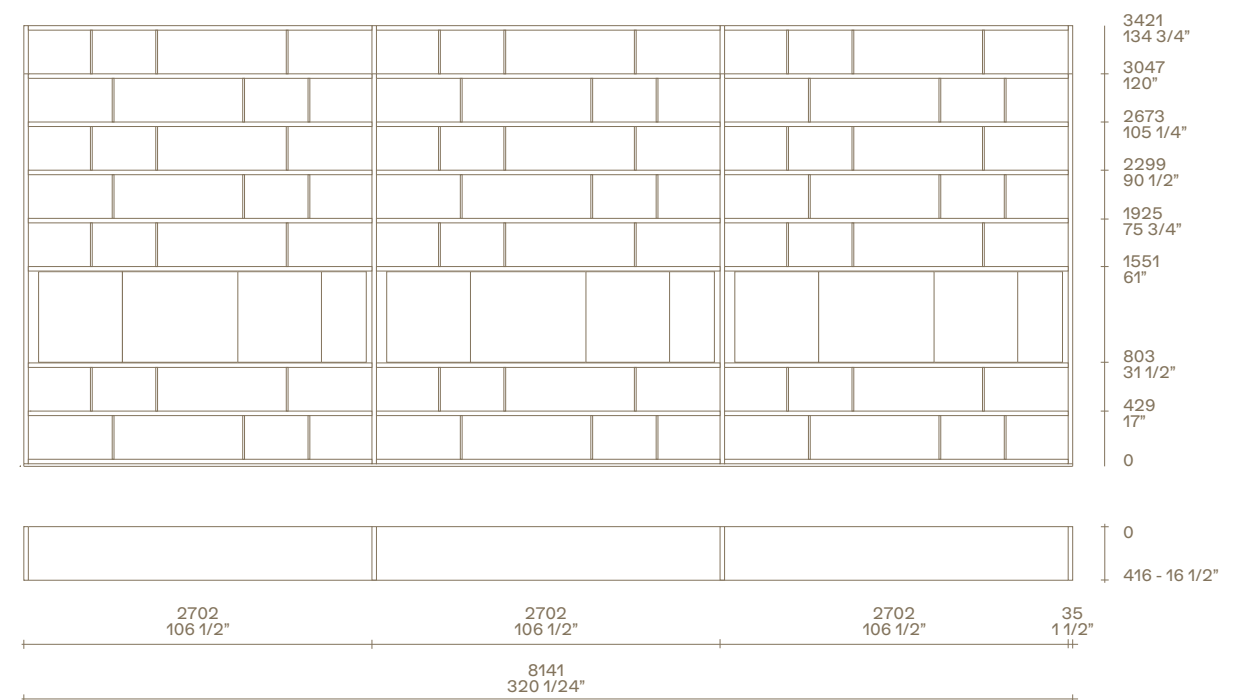

B

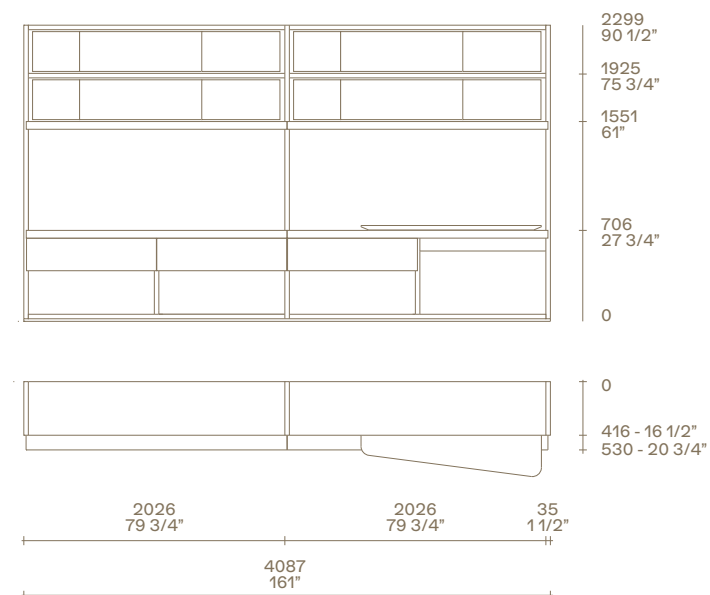





Qui e nelle pagine precedenti: composizione Wall System con struttura, fianchi centrali a telaio Ego Day, mensole e cassetti sospesi Ego Day in laccato opaco visone, schienali in laccato metallico titanio, luce a led integrata. Ante Ego Day e fianchi laterali in vetro trasparente e telaio laccato opaco visone. Tavolo Home Hotel in olmo nero con piano centrale girevole integrato in marmo noir saint laurent lucido. Sedie Ipanema con braccioli con struttura in olmo nero e rivestimento non sfoderabile in pelle Soft 4 cognac. Tappeto Plain tortora. Sotto: dettaglio della mensola con luce a led con cassetto sospeso Ego Day in laccato opaco visone.

Here and previous pages: Wall System composition with structure, Ego Day central frame sides, shelves and Ego Day hanging drawers in mat lacquer visone, backs in metal lacquer titanio, integrated led light. Ego Day doors and lateral sides in transparent glass with mat lacquered visone frame. Home Hotel table in black elm with integrated central swivel top in glossy marble noir saint laurent. Ipanema chairs with armrests with black elm structure and non-removable cover in leather Soft 4 cognac. Carpet Plain tortora. Below: close up of the shelf with led light with Ego Day hanging drawer in mat lacquer visone.



INTERIOR 03

Wall System

Struttura: laccato opaco visone.

Ego Day

Schienali: laccato opaco visone.
 Fianchi telaio centrali: laccato opaco visone.
 Fianchi telaio vetro: vetro trasparente 1000, telaio laccato opaco visone.
 Ante battenti: vetro trasparente 1000, telaio laccato opaco visone.
 Mensole con cassetto sospeso: laccato opaco visone, luce a led.
 Mensole: laccato opaco visone, luce a led.

Wall System

Structure: mat lacquer visone.

Ego Day

Backs: mat lacquer visone.
 Central frame sides: mat lacquer visone.
 Glass frame sides: trasparent glass 1000, frame mat lacquer visone.
 Leaf doors: trasparent glass 1000, frame mat lacquer visone.
 Shelves with hanging drawer: mat lacquer visone, led light.
 Shelves: mat lacquer visone, led light.

Wall System

Design R&D Poliform

Ego Day

Design Giuseppe Bavuso

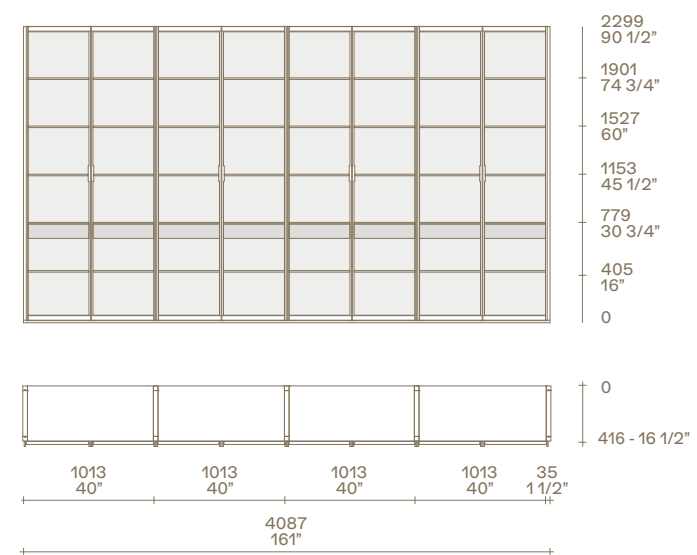





Qui e nelle pagine precedenti: composizione Wall System con struttura e ante battenti Slim in laccato opaco visone, schienali e fianchetti divisorii in laccato metallico titanio. Vettrine Ghost con ante in vetro trasparente extrachiaro, profilo verniciato opaco ardesia e schienali in laccato opaco canapa, luce a led integrata. Tappeto Plain tortora. A destra: dettaglio dell'anta Ghost in vetro trasparente extrachiaro con profilo verniciato opaco ardesia.

Here and previous pages: Wall System composition with structure and Slim leaf doors in mat lacquer visone, backs and partition sides in metal lacquer titanio. Ghost showcases with doors in extra light transparent glass, mat painted ardesia profile and backs in mat lacquer canapa, integrated led light. Carpet Plain tortora. To the right: close up of the Ghost door in extra light transparent glass with mat painted ardesia profile.





Qui e nella pagina precedente: composizione Wall System con struttura e ante battenti Slim in laccato opaco visone, schienali e fianchetti divisori in laccato metallico titanio. Portale TV in laccato opaco canapa con ante a ribalta Jet, luce a led integrata. Divano Mondrian in tessuto sfoderabile Zante 12 corda, cuscini in tessuto Sparta 18 panna, piedini brown nickel lucido. Accanto al divano, tavolino Paris Seoul con esterno in cuoio 26 invecchiato e interno in brown nickel lucido. Al centro, tavolino Mondrian con piano ovale in marmo calacatta oro opaco e struttura brown nickel lucido, tavolino Soori in metallo finitura bronzo anticato. Pouf Mondrian in velluto sfoderabile Persia 1404 carbone con piedini brown nickel lucido. Sotto: dettaglio dell'elemento Jet con ante a ribalta in laccato opaco canapa.

Here and previous page: Wall System composition with structure and Slim leaf doors in mat lacquer visone, backs and partition sides in metal lacquer titanio. TV-portal in mat lacquer canapa with Jet flap doors, integrated led light. Mondrian sofa in removable fabric Zante 12 corda, cushions in fabric Sparta 18 panna, glossy brown nickel feet. Next to the sofa, Paris Seoul coffee table with external finish hide 26 invecchiato and internal finish in glossy brown nickel. At the centre, Mondrian coffee table with oval top in mat marble calacatta oro and glossy brown nickel structure, Soori coffee table in metal with antique bronze finish. Mondrian pouf in removable velvet Persia 1404 carbone with glossy brown nickel feet. Below: close up of the Jet element with flap doors in mat lacquer canapa.



INTERIOR 04

Wall System A

Struttura: laccato opaco visone.
 Schienali: laccato metallico titanio.
 Fianchetti: laccato metallico titanio spessore mm 14.
 Ante Slim battente: laccato opaco visone.
 Vetrine Ghost a filo: anta vetro trasparente extrachiaro 2000 con profilo verniciato opaco ardesia, schienale laccato opaco canapa, luce a led.

Wall System B

Struttura: laccato opaco visone.
 Schienali: laccato metallico titanio.
 Fianchetti: laccato metallico titanio spessore mm 14.
 Ante Slim battente: laccato opaco visone.
 Portale TV: schienale, mensolone ed elemento Jet con ante a ribalta, laccato opaco canapa.
 Luce a led.

Wall System A

Structure: mat lacquer visone.
 Backs: metal lacquer titanio.
 Partitions: metal lacquer titanio thickness 1/2".
 Slim leaf doors: mat lacquer visone.
 Showcases Ghost: door in extra light transparent glass 2000 with mat painted ardesia profile, back mat lacquer canapa, led light.

Wall System B

Structure: mat lacquer visone.
 Backs: metal lacquer titanio.
 Partitions: metal lacquer titanio thickness 1/2".
 Slim leaf doors: mat lacquer visone.
 TV-portal: back, thick shelf and Jet element with flap doors, mat lacquer canapa.
 Led light.

Wall System Design R&D Poliform

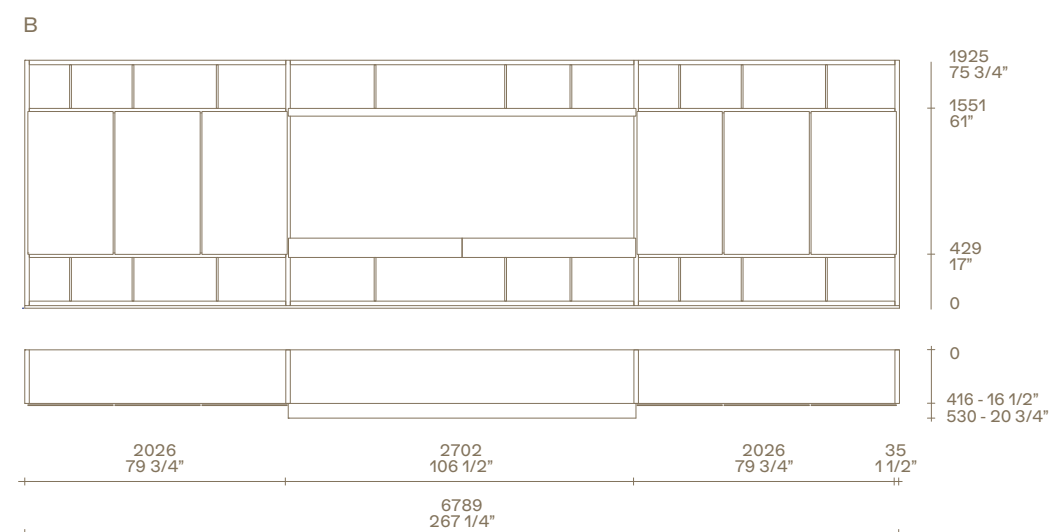
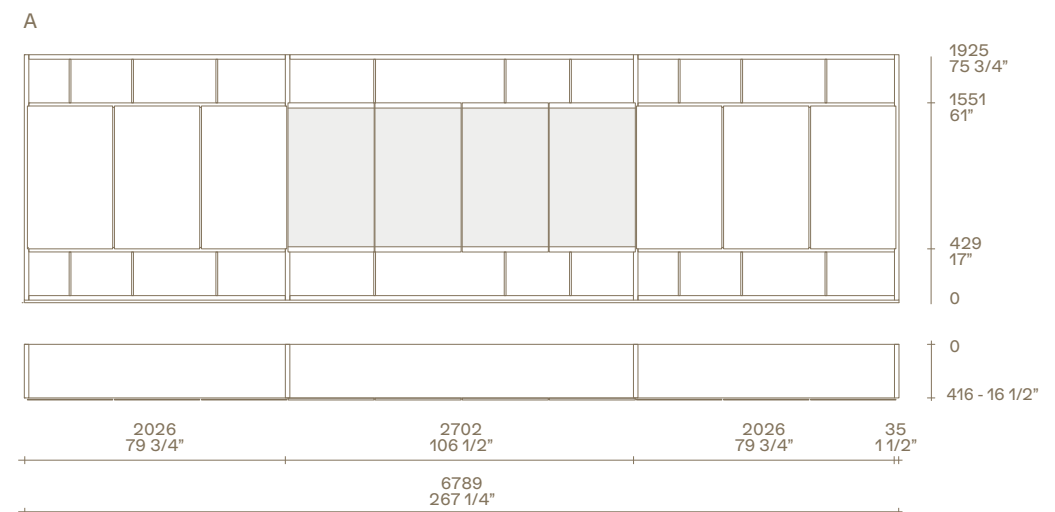





Qui e nelle pagine precedenti: composizione Wall System con struttura, schienali e inserti attrezzati in rovere spessart, ante a ribalta Slim in laccato opaco visone. Divano e pouf Paris Seoul in tessuto sfoderabile Kitami 04 sabbia, cuscini in velluto Persia 2006 prugna. Tavolino Paris Seoul in cuoio 02 nero e interno struttura in brown nickel opaco. Tavolini Tribeca con piani in marmo emperador dark lucido e struttura in brown nickel opaco. Sotto: dettaglio dell'inserto attrezzato sporgente.

Here and previous pages: Wall System composition with structure, backs and accessorized inserts in spessart oak, Slim flap doors in mat lacquer visone. Paris Seoul sofa and pouf in removable fabric Kitami 04 sabbia, cushions in velvet Persia 2006 prugna. Paris Seoul coffee table in hide 02 nero e interno struttura in mat brown nickel. Tribeca coffee tables with tops in glossy marble emperador dark and structure in mat brown nickel. Below: close up of the accessorized jutting insert.







Qui e nella pagina precedente: composizione Wall System con struttura e anta a ribalta Jet in rovere spessart, griglie in laccato opaco piombo e luce a led integrata. Pouf Onda in velluto sfoderabile Persia 1401 oliva. A sinistra: dettaglio del vano attrezzato ad uso scrittoio, cassetti e interno anta a ribalta Jet rivestiti in cuoio 02 nero, canalina attrezzata con prese elettriche e usb.

Here and previous page: Wall System composition with structure and Jet flap door in spessart oak, grids in mat lacquer piombo and integrated led light. Onda pouf in removable velvet Persia 1401 oliva. To the left: close up of the open compartment used as writing desk, drawers and interior of the Jet flap door covered in hide 02 nero, channel equipped with electrical outlets and usb.



INTERIOR 05

Wall System A

Struttura: rovere spessart.
 Schienali: rovere spessart.
 Inserti attrezzati sporgenti: rovere spessart.
 Ante Slim a ribalta: laccato opaco visone.

Wall System B

Struttura: rovere spessart.
 Schienali: rovere spessart.
 Griglie spessore mm 14: laccato opaco
 piombo.
 Anta a ribalta Jet uso scrittoio: rovere
 spessart, interno anta cuoio 02 nero,
 contenitore a tre cassetti cuoio 02 nero,
 luce a led.

Wall System A

Structure: spessart oak.
 Backs: spessart oak.
 Jutting accessorized inserts: spessart oak.
 Slim flap doors: mat lacquer visone.

Wall System B

Structure: spessart oak.
 Backs: spessart oak.
 Grids thickness 1/2": mat lacquer
 piombo.
 Jet flap doors for desk use: spessart oak,
 door interior hide 02 nero, storage
 unit with three drawers hide 02 nero,
 led light.

Wall System
 Design R&D Poliform

A

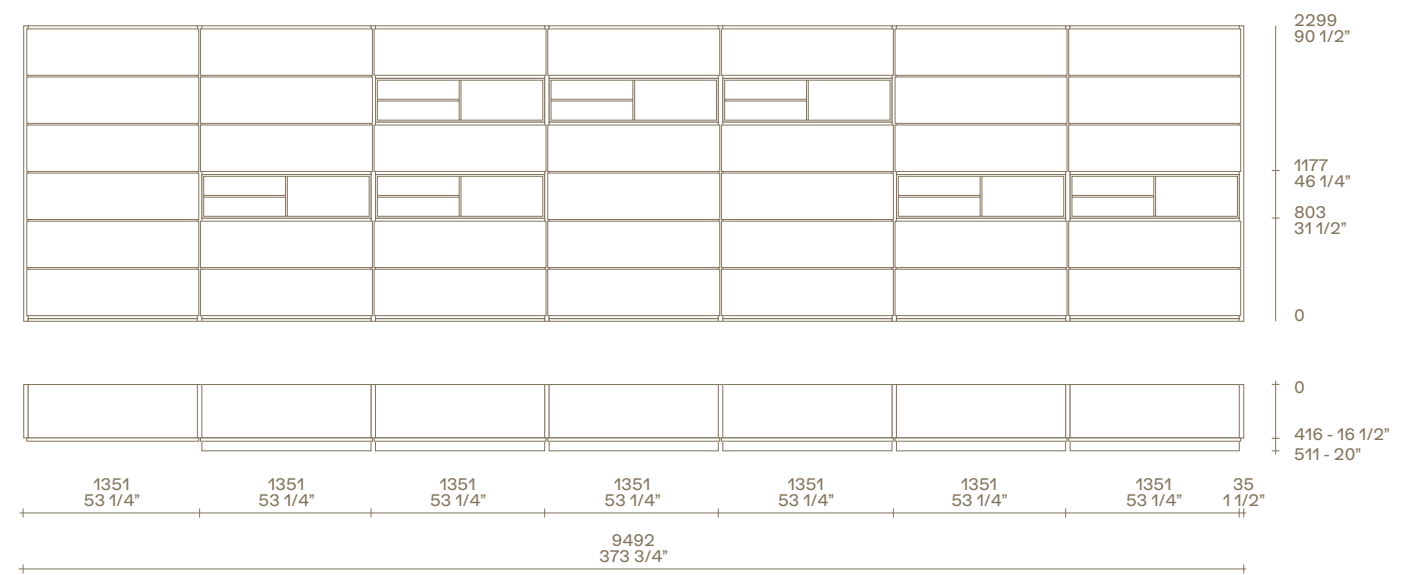

B

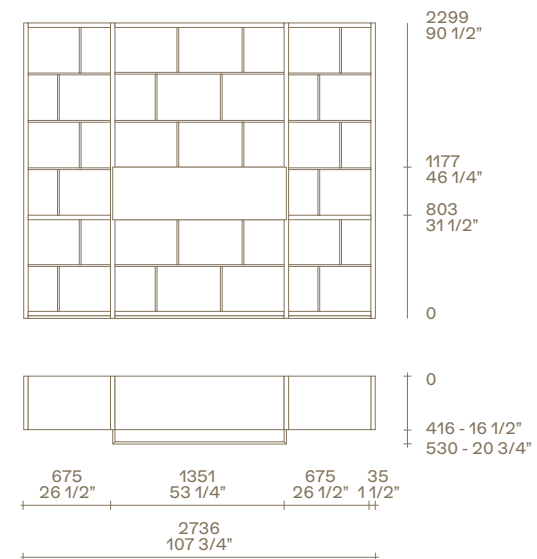

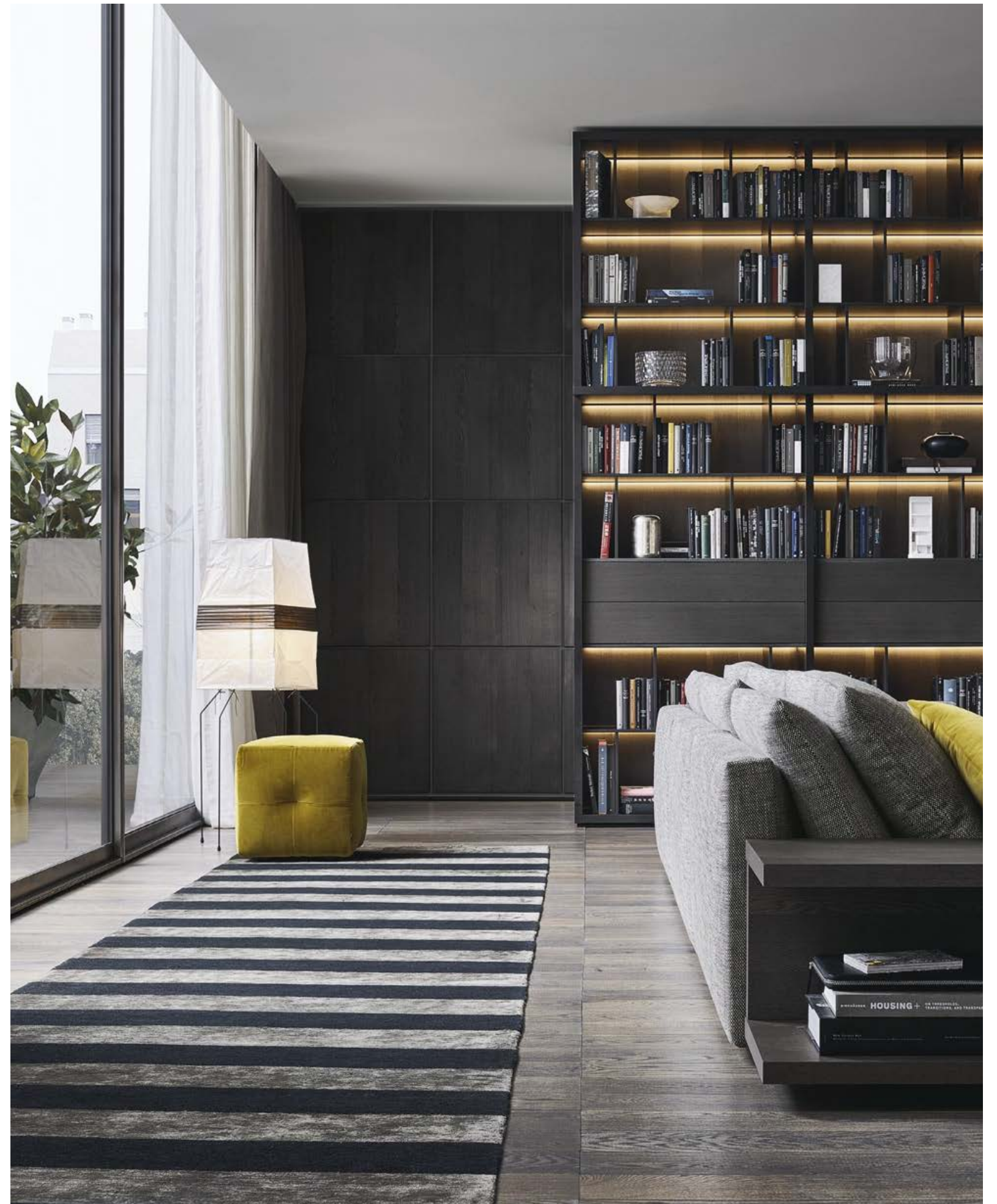



Qui, nelle pagine precedenti e nella successiva: composizione Wall System con struttura in laccato lucido moka, schienali e cassetti Flat in olmo nero, griglie e fianchetti divisorio vano TV in laccato opaco moka, ante scorrevoli Bold in cuoio 02 nero, luce a led integrata. Composizione Wall System con struttura in laccato lucido moka e ante battenti Slim in olmo nero. Divano Bristol con cuscineria doppia in tessuto sfoderabile Rabat 412 cemento, cuscini in velluto Persia 1403 oca e 1404 carbone. Pouf Bristol in velluto sfoderabile Persia 1404 carbone. Madia e tavolini Bristol in olmo nero, piedini in brown nickel opaco. Poltrone Mad Chair in velluto sfoderabile Persia 1404 carbone, gambe in olmo nero. Sotto: dettaglio dell'anta scorrevole Bold in cuoio 02 nero con maniglia ardesia opaco.

Here, previous pages and next page: Wall System composition with structure in glossy lacquer moka, backs and Flat drawers in black elm, grids and TV-unit partitions in mat lacquer moka, Bold sliding doors in hide 02 nero, integrated led light. Wall System composition with structure in glossy lacquer moka and Slim leaf doors in black elm. Bristol sofa with double backrest cushion in removable fabric Rabat 412 cemento, cushions in velvet Persia 1403 oca and 1404 carbone. Bristol pouf in removable velvet Persia 1404 carbone. Sideboard and coffee tables Bristol in black elm, mat brown nickel feet. Mad Chair armchairs in removable velvet Persia 1404 carbone, legs in black elm. Below: close up of the Bold sliding door in hide 02 nero with mat ardesia handle.







A sinistra: dettaglio dei cassetti Flat e del ripiano superiore sagomato in olmo nero, interno cassetto in nobilitato ardesia. Sotto: dettaglio dell'anta battente Slim in olmo nero con apertura a pressione.

To the left: close up of the Flat drawers and of the upper shaped shelf in black elm, drawer interior in melamine ardesia. Below: close up of the Slim leaf door in black elm with push-pull opening.



In questa pagina: dettaglio della griglia con ripiani e fianchetti divisori in laccato opaco moka, luce a led integrata, schienale in olmo nero.

This page: close up of the grid with shelves and partition sides in mat lacquer moka, integrated led light, back in black elm.



INTERIOR 06

Wall System A

Struttura: laccato lucido moka.
 Schienali: olmo nero.
 Griglie spessore mm 14: laccato opaco moka.
 Cassetti Flat: olmo nero.
 Vano TV: schienali olmo nero, ripiani laccato lucido moka, fianchetti e ripiani spessore mm 14 laccato opaco moka.
 Ante Bold scorrevoli: cuoio 02 nero, binario laccato opaco moka, maniglia Bold verniciato ardesia opaco.
 Luce a led.

Wall System B

Struttura: laccato lucido moka.
 Schienali: olmo nero.
 Ante Slim battente: olmo nero.

Wall System A

Structure: glossy lacquer moka.
 Backs: black elm.
 Grids thickness 1/2": mat lacquer moka.
 Flat drawers: black elm.
 TV-unit: backs black elm, shelves glossy lacquer moka, partitions and shelves thickness 1/2" mat lacquer moka.
 Bold sliding doors: hide 02 nero, mat lacquered moka rail, mat painted ardesia Bold handle.
 Led light.

Wall System B

Structure: glossy lacquer moka.
 Backs: black elm.
 Slim leaf door: black elm.

Wall System
 Design R&D Poliform

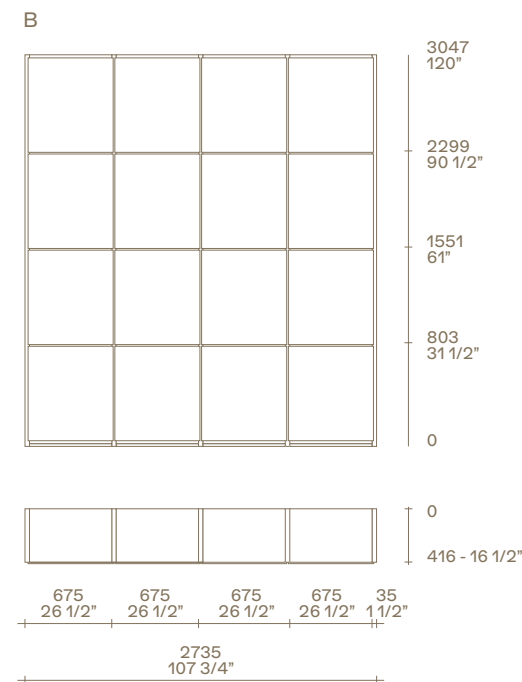
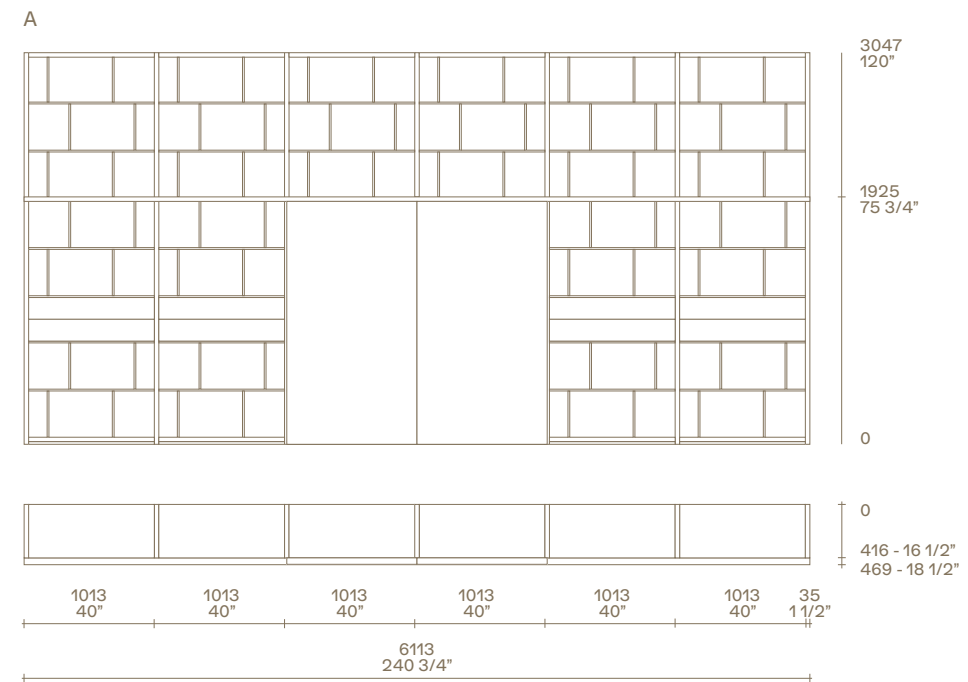







Qui e nelle pagine precedenti: composizione Wall System con struttura in rovere spessart, ante a ribalta Slim in laccato opaco visone, griglie in laccato opaco carbone con luce a led integrata. Sedie Guest con rivestimento non sfoderabile in tessuto Naxos 18 canapa, cuscino seduta sfoderabile nella stessa finitura. Pouf Onda in velluto sfoderabile Persia 2006 prugna.

Here and previous pages: Wall System composition with structure in spessart oak, Slim flap doors in mat lacquer visone, grids in mat lacquer carbone with integrated led light. Guest chairs with non-removable cover in fabric Naxos 18 canapa, removable seat cushion in the same finish. Onda pouf in removable velvet Persia 2006 prugna.



Qui e nella pagina successiva: composizione Wall System con struttura, schienali, fianchi centrali a telaio Ego Day e mensole con contenitore a giorno in rovere spessart, mensole in laccato opaco piombo, luce a led integrata. Ante Ego Day e fianchi laterali in vetro trasparente riflettente e telaio laccato opaco carbone. Sedie Guest con rivestimento non sfoderabile in tessuto Naxos 18 canapa, cuscino seduta sfoderabile nella stessa finitura. Pouf Onda in velluto sfoderabile Persia 2006 prugna. Tappeto Dama.

Here and following page: Wall System composition with structure, backs, Ego Day central frame sides and shelves with open compartment in spessart oak, shelves in mat lacquer piombo, integrated led light. Ego Day doors and lateral sides in transparent reflecting glass and mat lacquered carbone frame. Guest chairs with non-removable cover in fabric Naxos 18 canapa, removable seat cushion in the same finish. Onda pouf with removable cover in velvet Persia 2006 prugna. Carpet Dama.







A sinistra: dettaglio dell'anta Ego Day in vetro trasparente riflettente con telaio e maniglia integrata in laccato opaco carbone, contenitore a giorno in rovere spessart e mensola in laccato opaco piombo, luce a led integrata.

To the left: close up of the Ego Day door in transparent reflecting glass with frame and integrated handle in mat lacquer carbone, open storage unit in spessart oak and shelf in mat lacquer piombo, integrated led light.

INTERIOR 07

Wall System A

Struttura: rovere spessart.
 Schienali: rovere spessart.
 Griglia spessore mm 14: laccato opaco carbone.
 Ante Slim a ribalta: laccato opaco visone.
 Luce a led.

Wall System B

Struttura: rovere spessart.

Ego Day

Schienali: rovere spessart.
 Fianchi telaio centrali: laccato opaco carbone.
 Fianchi telaio vetro: vetro trasparente riflettente 5000, telaio rovere spessart.
 Ante battente: vetro trasparente riflettente 5000, telaio laccato opaco carbone.
 Mensole con contenitore a giorno: rovere spessart, luce a led.
 Mensole: laccato opaco piombo, luce a led.

Wall System A

Structure: spessart oak.
 Backs: spessart oak.
 Grid thickness 1/2": mat lacquer carbone.
 Slim flap doors: mat lacquer visone.
 Led light.

Wall System B

Structure: spessart oak.

Ego Day

Backs: spessart oak.
 Central frame sides: mat lacquer carbone.
 Glass frame sides: transparent reflecting glass 5000, frame spessart oak.
 Leaf door: transparent reflecting glass 5000, frame mat lacquer carbone.
 Shelves with open compartment: spessart oak, led light.
 Shelves: mat lacquer piombo, led light.

Wall System

Design R&D Poliform

A

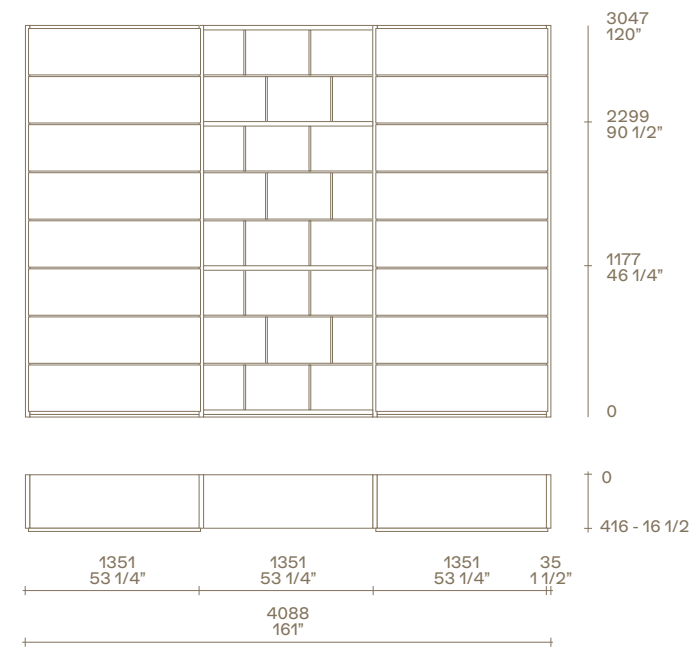

Wall System

Design R&D Poliform

Ego Day

Design Giuseppe Bavuso

B

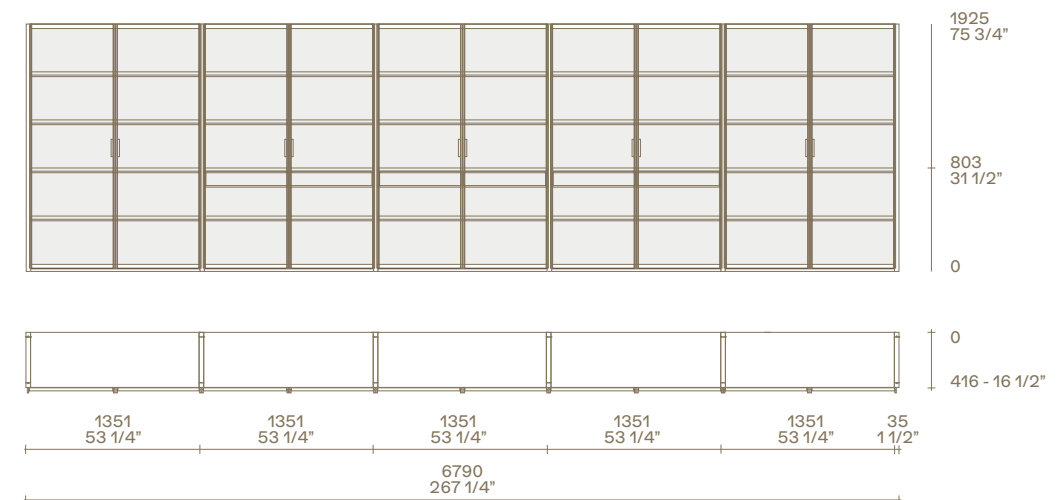







Qui e nelle pagine precedenti: composizioni Wall System con struttura in rovere spessart. Vettrine sporgenti Ghost con ante in vetro trasparente riflettente, profilo verniciato opaco ardesia e schienali in laccato opaco caramello, luce a led integrata. Divano e pouf Tribeca in tessuto sfoderabile Oxford 11 sabbia, cuscini in velluto Persia 1404 carbone e piedini in brown nickel opaco. Tavolino Tribeca con struttura in brown nickel opaco e piano in marmo calacatta oro lucido. Tavolino Baba in brown nickel opaco e piano in marmo emperador dark lucido. Poltrone Santa Monica Home in tessuto sfoderabile Naxos 27 prussia. A sinistra: dettaglio della vetrina sporgente Ghost in vetro trasparente riflettente con profilo verniciato opaco ardesia.

Here and previous pages: Wall System compositions with structure in spessart oak. Jutting Ghost showcases with doors in transparent reflecting glass, mat ardesia painted profile and backs in mat lacquer caramello, integrated led light. Sofa and pouf Tribeca in removable fabric Oxford 11 sabbia, cushions in velvet Persia 1404 carbone and mat brown nickel feet. Tribeca coffee table with mat brown nickel structure and top in glossy marble calacatta oro. Baba coffee table in mat brown nickel and top in glossy marble emperador dark. Santa Monica Home armchairs in removable fabric Naxos 27 prussia. To the left: close up of the jutting Ghost showcase in transparent reflecting glass with mat painted ardesia profile.





Qui e nella pagina precedente: composizione Wall System con struttura in rovere spessart, griglie in laccato opaco ardesia e luce a led. Ribalta sporgente Jet in rovere spessart e vano attrezzato in versione bar con schienale a specchio bianco, interno anta a ribalta Jet rivestito in cuoio 02 nero e ripiano a ponte in vetro trasparente extrachiario. Poltrona Santa Monica Home in tessuto sfoderabile Naxos 27 prussia. Pouf Onda in velluto sfoderabile Persia 1403 ocra. Tavolino Tribeca con struttura in brown nickel opaco e piano in marmo calacatta oro lucido. Divano Tribeca in tessuto sfoderabile Oxford 11 sabbia, cuscini in velluto Persia 1404 carbone e piedini in brown nickel opaco.

Here and previous pages: Wall System compositions with structure in spessart oak, grids in mat lacquer ardesia and led light. Jet jutting flap door in spessart oak and equipped compartment in bar version with back in white mirror, Jet flap door interior covered in hide 02 nero and bridge shelf in extra light transparent reflecting glass. Santa Monica Home armchair in removable fabric Naxos 27 prussia. Onda pouf in removable velvet Persia 1403 ocra. Tribeca coffee table with mat brown nickel structure and top in glossy marble calacatta oro. Tribeca sofa in removable fabric Oxford 11 sabbia, cushions in velvet Persia 1404 carbone and mat brown nickel feet.







Qui e nella pagina precedente: composizione Wall System con struttura in laccato opaco visone, griglie in laccato metallico bronzo, schienali, anta a ribalta e cassetti Jet in noce gold, luce a led. Divano Bristol con cuscineria libera in pelle sfoderabile Nabuk 02 tortora. Tavolino Tribeca con struttura in brown nickel opaco e piano in marmo calacatta oro levigato. Tavolino Baba in brown nickel opaco e piano in laccato opaco carbone. Poltrone Mad Chair in velluto sfoderabile Persia 54 prussia, gambe in rovere spessart. Sotto: dettaglio del vano TV con contenitore sporgente Jet con apertura a ribalta.

Here and previous page: Wall System composition with structure in mat lacquer visone, grids in metal lacquer bronzo, backs, flap door and drawers Jet in gold walnut, led light. Bristol sofa with loose cushions in removable leather Nabuk 02 tortora. Tribeca coffee table with mat brown nickel structure and top in mat marble calacatta oro levigato. Baba coffee table in mat brown nickel and top in mat lacquer carbone. Mad Chair armchairs in removable velvet Persia 54 prussia, legs in spessart oak. Below: close up of the TV-unit with jutting storage unit Jet with flap doors.

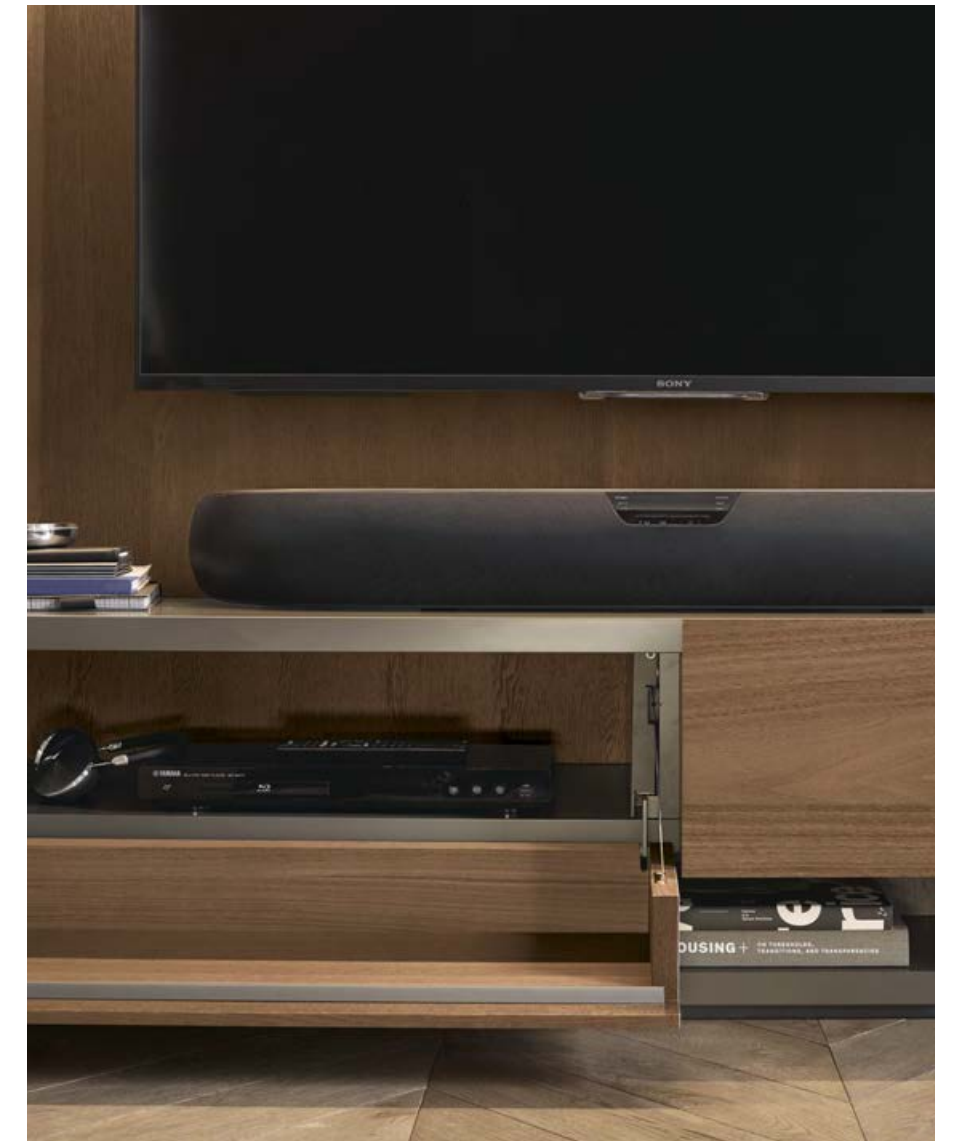

INTERIOR 08

Wall System A

Struttura: rovere spessart.
Vetrine Ghost sporgenti: anta vetro trasparente riflettente 5000 con profilo verniciato opaco ardesia, schienale laccato opaco caramello, luce a led.

Wall System B

Struttura: rovere spessart.
Griglia spessore mm 14: laccato opaco ardesia, schienali rovere spessart.
Anta a ribalta Jet uso bar: rovere spessart, interno anta cuoio 02 nero, ripiano a ponte vetro trasparente extrachiario 2000, schienale specchio bianco, luce a led.
Luce a led.

Wall System C

Struttura: laccato opaco visone.
Schienali: noce gold.
Griglia spessore mm 14: laccato metallico bronzo.
Vano TV: schienali noce gold, ante a ribalta Jet noce gold, fianchetti laccato metallico bronzo spessore mm 14.
Cassetto Jet: noce gold.
Luce a led.

Wall System A

Structure: spessart oak.
Jutting Ghost showcases: door transparent reflecting glass 5000 with mat painted ardesia profile, mat lacquered caramello back, led light.

Wall System B

Structure: spessart oak.
Grid thickness 1/2": mat lacquer ardesia, backs spessart oak.
Jet flap door for bar use: spessart oak, door interior hide 02 nero, bridge shelf extra light transparent glass 2000, back white mirror, led light.
Led light.

Wall System C

Structure: mat lacquer visone.
Backs: gold walnut.
Grid thickness 1/2": metal lacquer bronzo.
TV-unit: backs gold walnut, Jet flap door gold walnut, partitions metal lacquer bronzo thickness mm 14.
Jet drawer: gold walnut.
Led light.

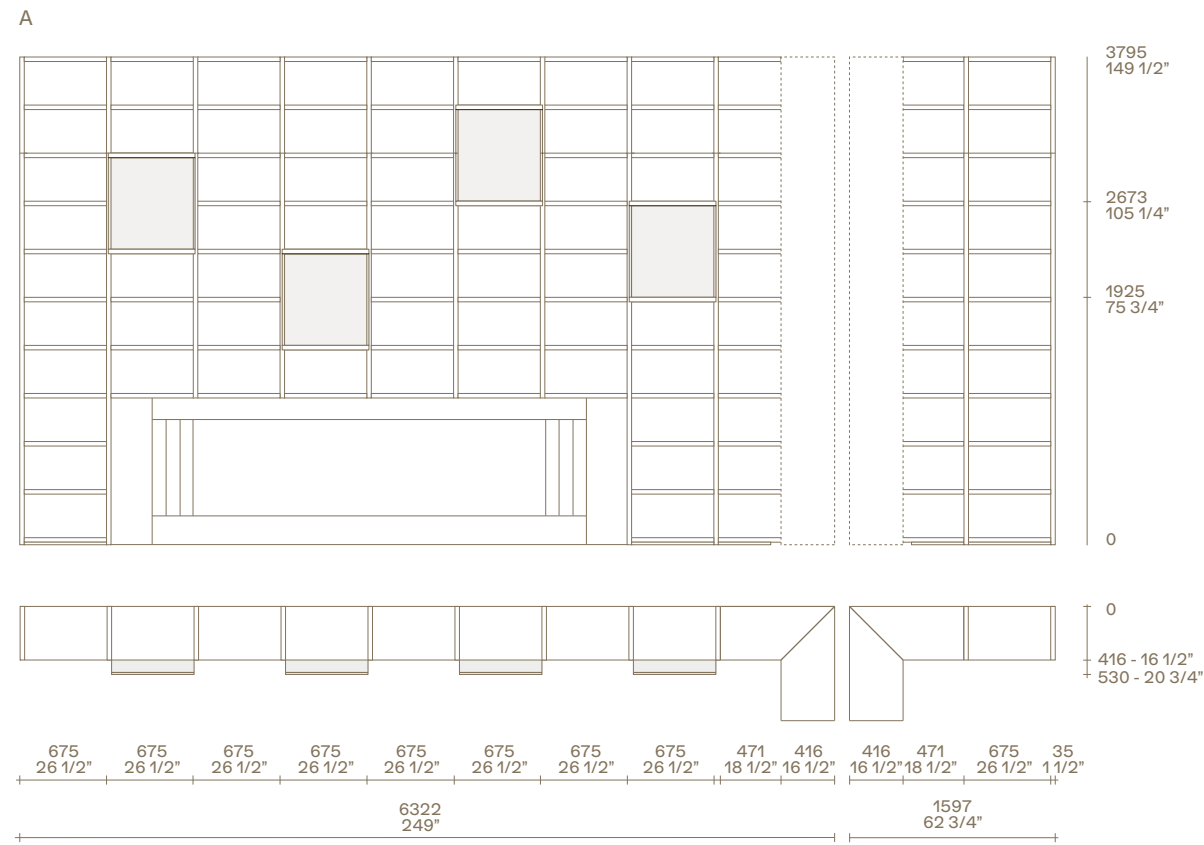

Wall System

Design R&D Poliform

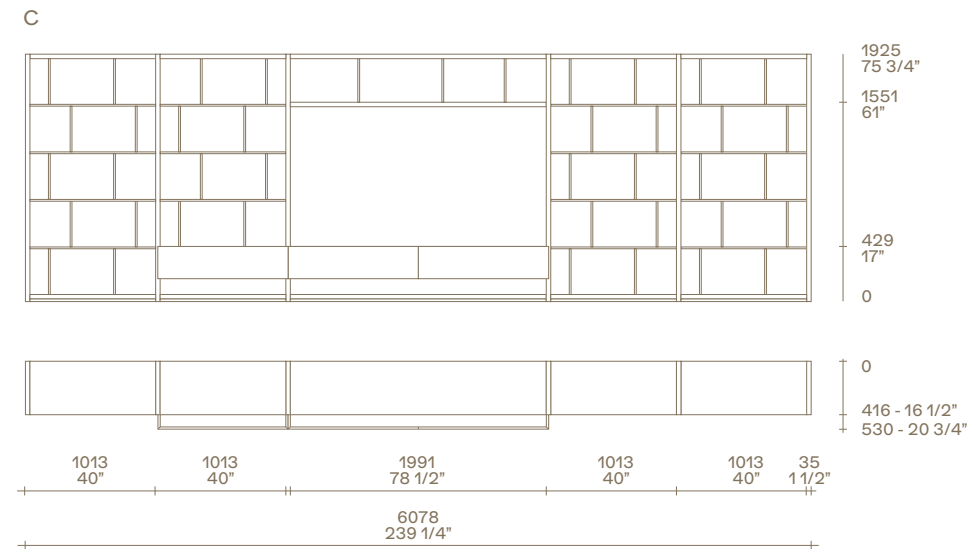
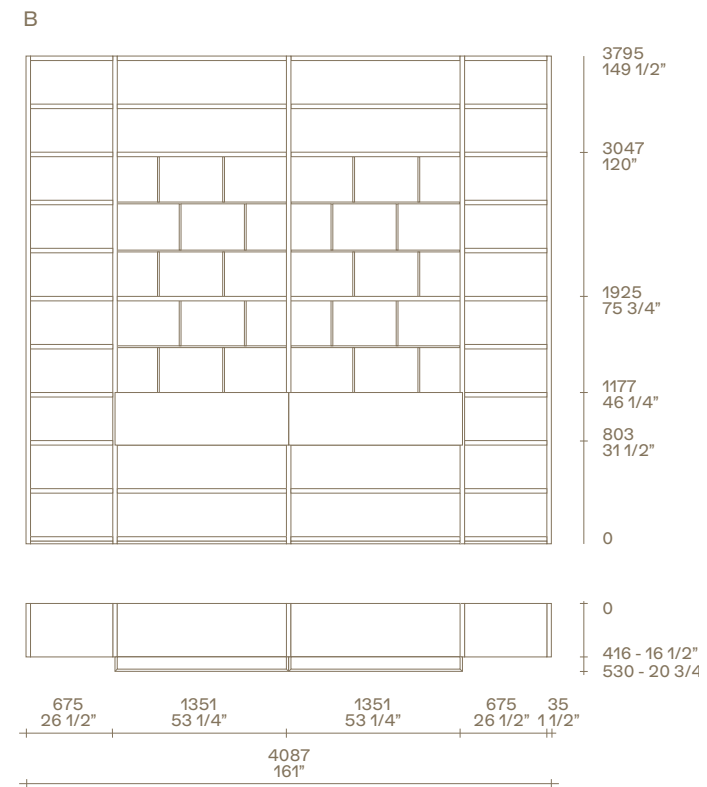

WALL SYSTEM

COMPOSITION 01	110
COMPOSITION 02	112
COMPOSITION 03	114
COMPOSITION 04	116
COMPOSITION 05	118
COMPOSITION 06	120
COMPOSITION 07	122
COMPOSITION 08	124
COMPOSITION 09	126
COMPOSITION 10	128

COMPOSITION 01

Struttura
Rovere spessart

Schienali
Laccato opaco arena

Frontali Slim
Rovere spessart

Luci a led
Verniciato ardesia

Structure
Spessart oak

Backs
Mat lacquer arena

Slim fronts
Spessart oak

Led lights
Painted ardesia



L 4226 P 446 H 2673
W 166 1/2" D 17 1/2" H 105 1/4"

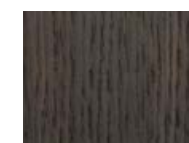
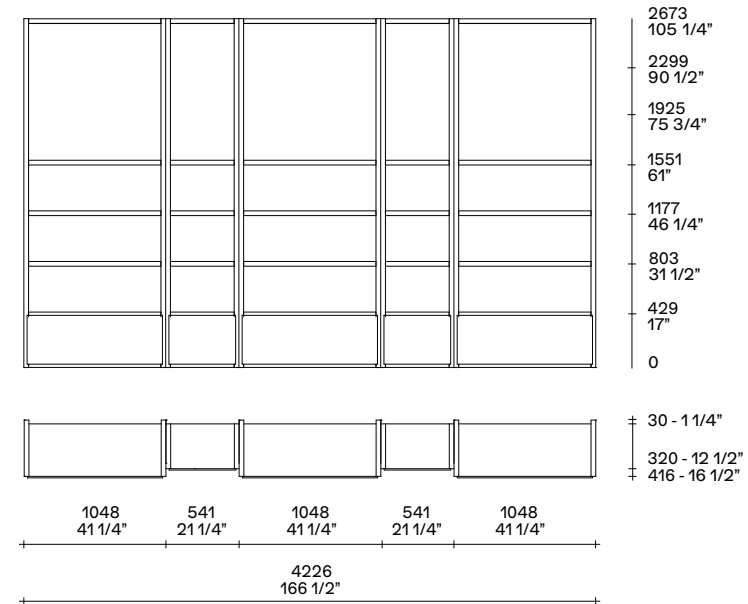

rovere spessart
spessart oak



64 arena
laccato opaco
mat lacquer

COMPOSITION 02

Struttura
Laccato opaco roccia

Schienali e portale
Olmo nero

Schienali inclinati
Gres porcellanato lucido sahara noir

Griglie
Laccato metallico ottone

Ante ribalta Jet, mensole, portale
Olmo nero

Luci a led
Verniciato ardesia

Structure
Mat lacquer roccia

Backs and portal
Black elm

Oblique backs
Glossy gres porcelain sahara noir

Grids
Metal lacquer ottone

Jet flap doors, shelves, portal
Black elm

Led lights
Painted ardesia



L 5439 P 560 H 1925
W 214 1/4" D 22" H 75 3/4"

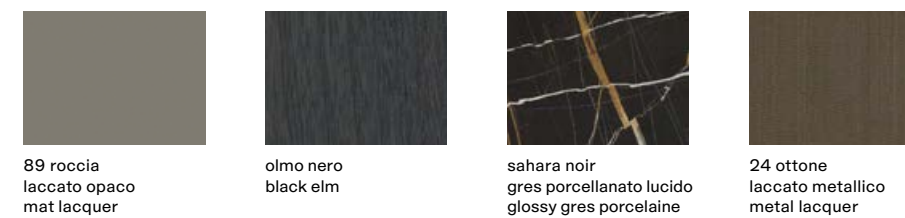
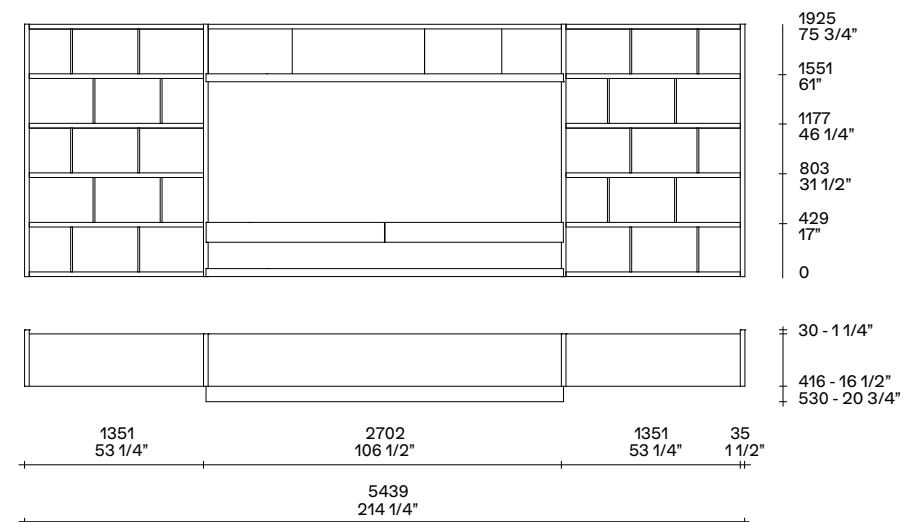

COMPOSITION 03

Struttura, mensole e griglie
Laccato opaco arena

Schienali, portale
Laccato metallico titanio

Ante vetro Ghost
Vetro trasparente riflettente

Telaio
Laccato opaco ardesia

Schienali vetrine Ghost
Olmo nero

Luci a led
Verniciato ardesia

Structure, shelves and grids
Mat lacquer arena

Backs and portal
Metal lacquer titanio

Ghost glass doors
Reflecting transparent glass

Frame
Mat lacquer ardesia

Ghost showcases backs
Black elm

Led lights
Painted ardesia



L 6111 P 560 H 1925
W 240 1/2" D 22" H 75 3/4"

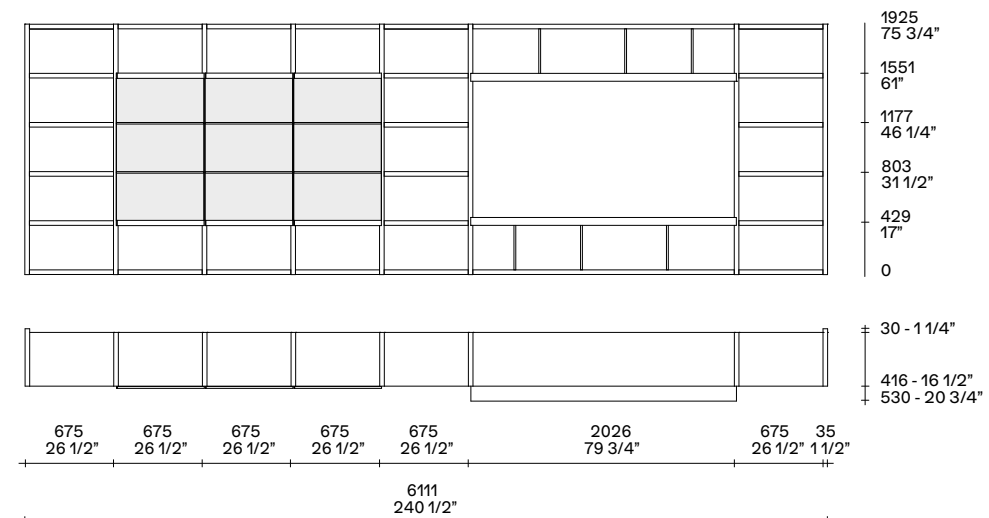

64 arena
laccato opaco
mat lacquer



25 titanio
laccato metallico
metal lacquer

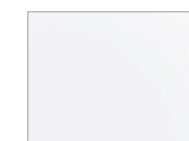

5000 vetro trasparente
riflettente - reflecting
transparent glass

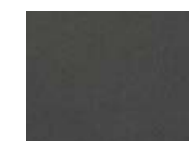

02 ardesia
laccato opaco
mat lacquer



olmo nero
black elm

COMPOSITION 04

Struttura, ante e cassetti Slim
Laccato lucido canapa

Schienali
Olmo nero

Schienali inclinati
Gres porcellanato lucido emperador dark

Ante vetro Ghost
Vetro riflettente trasparente

Telaio
Laccato opaco ardesia

Schienali vetrine Ghost
Laccato metallico ottone

Luci a led
Verniciato ardesia

Structure, Slim doors and drawers
Glossy lacquer canapa

Backs
Black elm

Oblique backs
Glossy gres porcelain emperador dark

Ghost glass doors
Reflecting transparent glass

Frame
Mat lacquer ardesia

Ghost showcases backs
Metal lacquer ottone

Led lights
Painted ardesia



L 5437 P 446 H 1925
W 214" D 17 1/2" H 75 3/4"

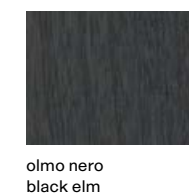
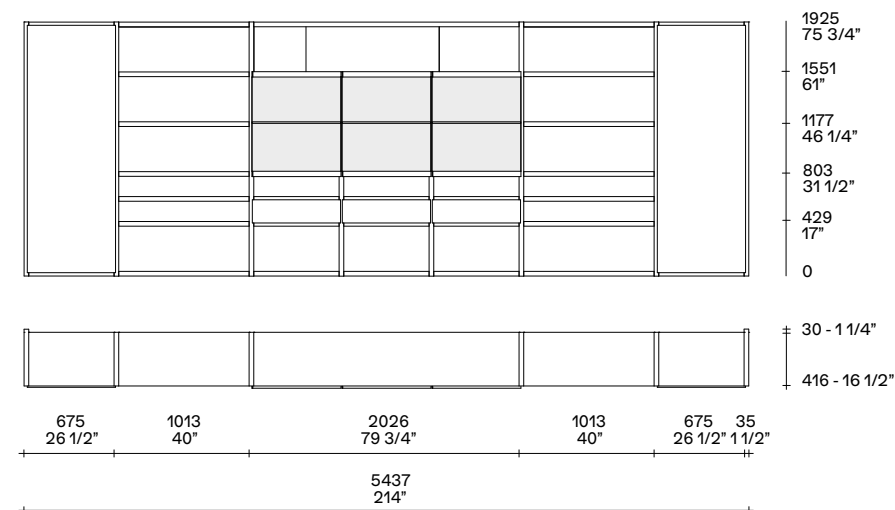

COMPOSITION 05

Struttura, griglie

Laccato opaco canapa

Schienali, ante Slim

Noce gold

Schienali inclinati

Gres porcellanato lucido calacatta oro

Ante vetro Ghost

Vetro riflettente trasparente

Telaio

Laccato opaco ardesia

Schienali vetrine Ghost

Laccato lucido granata

Luci a led

Verniciato ardesia

Structure, grids

Mat lacquer canapa

Backs, Slim doors

Gold walnut

Oblique backs

Glossy gres porcelain calacatta oro

Ghost glass doors

Reflecting transparent glass

Frame

Mat lacquer ardesia

Ghost showcases backs

Glossy lacquer granata

Led lights

Painted ardesia



L 4763 P 446 H 2299
W 187 1/2" D 17 1/2" H 90 1/2"

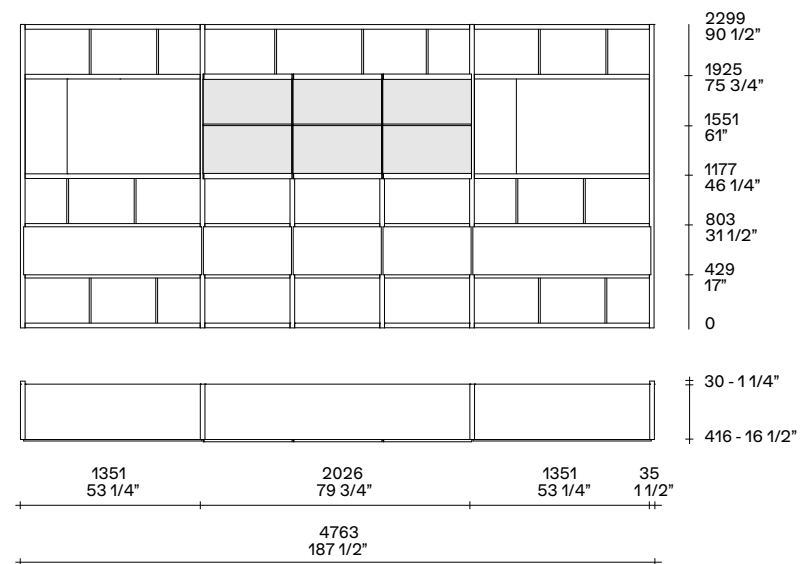

35 canapa
laccato opaco
mat lacquer

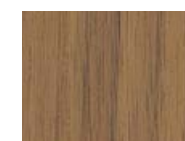

noce gold
gold walnut



calacatta oro
gres porcellanato lucido
glossy gres porcelaine

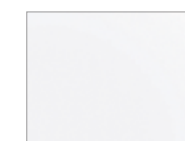

5000 vetro trasparente
riflettente - reflecting
transparent glass

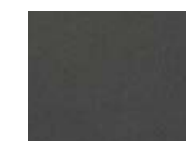

02 ardesia
laccato opaco
mat lacquer



87 granata
laccato lucido
glossy lacquer

COMPOSITION 06

Struttura
Laccato opaco roccia

Ante e cassetti Slim, mensole
Rovere spessart

Schienali, griglie
Laccato metallico titanio

Schienali inclinati
Gres porcellanato lucido calacatta oro

Ante vetro Ghost
Vetro riflettente trasparente

Telaio
Laccato opaco ardesia

Luci a led
Verniciato ardesia

Structure
Mat lacquer roccia

Slim doors and drawers, shelves
Spessart oak

Backs, grids
Metal lacquer titanio

Oblique backs
Glossy gres porcelain calacatta oro

Ghost glass doors
Transparent reflecting glass

Frame
Mat lacquer ardesia

Led lights
Painted ardesia



L 6113 P 446 H 2299
W 240 3/4" D 17 1/2" H 90 1/2"

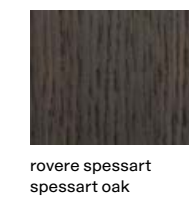
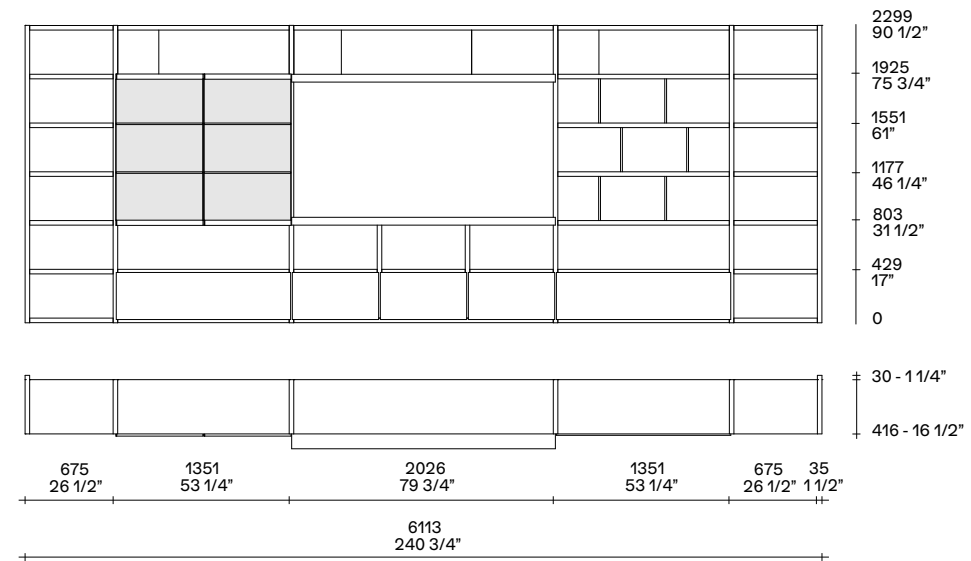

COMPOSITION 07

Struttura, ante Slim
Laccato opaco visone

Ante ribalta Jet, mensole, portale
Laccato opaco canapa

Schienali, griglie
Laccato metallico titanio

Luci a led
Verniciato ardesia

Structure, Slim doors
Mat lacquer visone

Jet flap doors, shelves, portal
Mat lacquer canapa

Backs, grids
Metal lacquer titanio

Led lights
Painted ardesia



L 5439 P 560 H 1925
W 214 1/4" D 22" H 75 3/4"

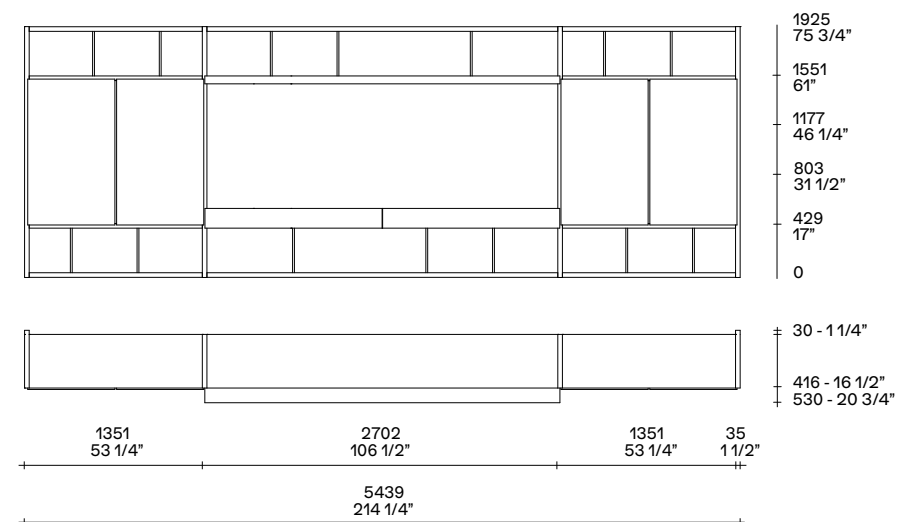

48 visone
laccato opaco
mat lacquer

35 canapa
laccato opaco
mat lacquer

25 titanio
laccato metallico
metal lacquer

COMPOSITION 08

- | | |
|--|--|
| Struttura
Laccato lucido moka | Structure
Glossy lacquer moka |
| Ante Slim, schienali
Olmo nero | Slim doors, backs
Black elm |
| Griglie
Laccato metallico titanio | Grids
Metal lacquer titanio |
| Ante vetro Ghost
Vetro riflettente trasparente | Ghost glass doors
Transparent reflecting glass |
| Telaio
Laccato opaco ardesia | Frame
Mat lacquer ardesia |
| Luci a led
Verniciato ardesia | Led lights
Painted ardesia |



L 4763 P 446 H 1925
W 187 1/2" D 17 1/2" H 75 3/4"

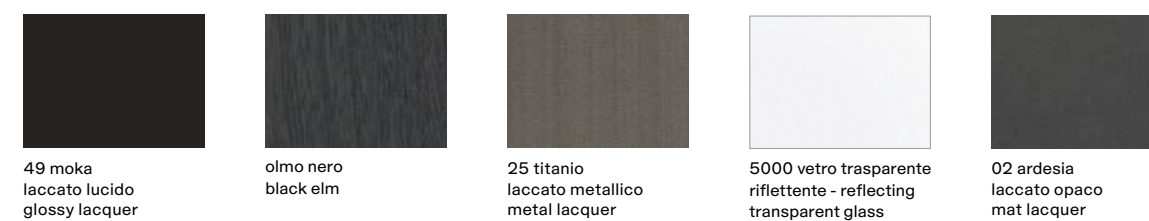
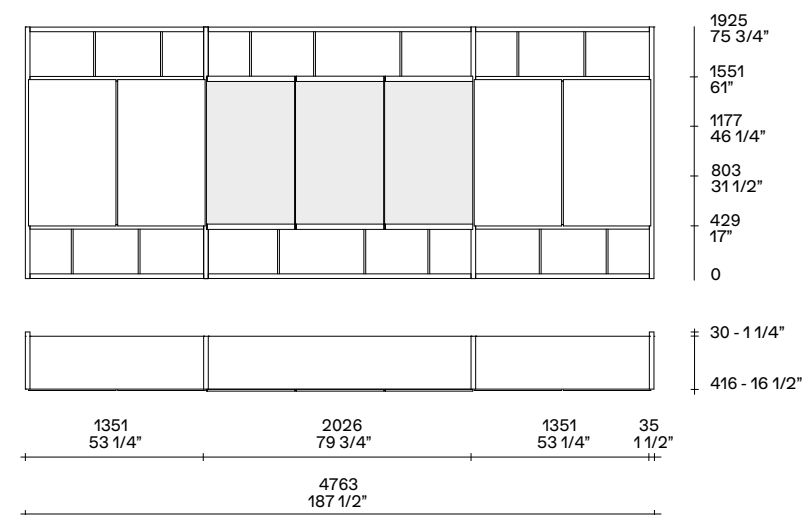

COMPOSITION 09

Struttura, cassetti Flat

Rovere spessart

Anta ribalta Jet

Rovere spessart con inserto cuoio nero

Schienali, griglie

Laccato metallico bronzo

Schienali inclinati

Gres porcellanato lucido sahara noir

Luci a led

Verniciato ardesia

Structure, Flat drawers

Spessart oak

Jet flap door

Spessart oak with insert hide nero

Backs, grids

Metal lacquer bronzo

Oblique backs

Glossy gres porcelain sahara noir

Led lights

Painted ardesia



L 5437 P 560 H 3047
W 214" D 22" H 120"

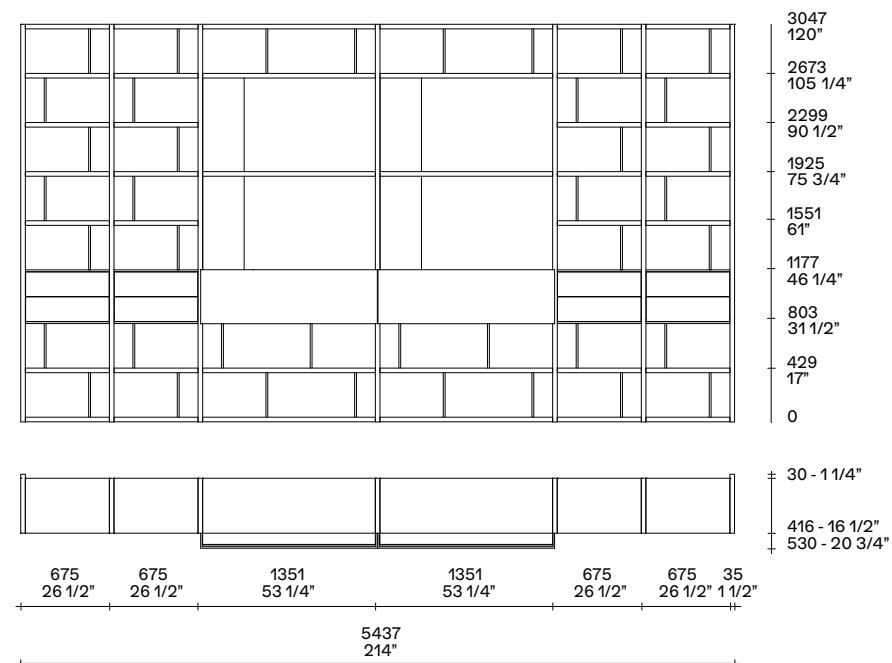

rovere spessart
spessart oak

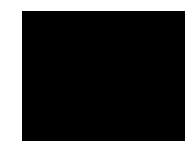

02 nero
cuoio - hide



23 bronzo
laccato metallico
metal lacquer

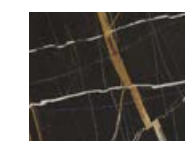

sahara noir
gres porcellanato lucido
glossy gres porcelaine

COMPOSITION 10

Struttura, ripiani interni
Laccato opaco visone

Ante vetro Ego, fianchi
Vetro trasparente

Telaio
Laccato opaco visone

Schienali
Laccato metallico titanio

Luci a led
Verniciato ardesia

Structure, inner shelves
Mat lacquer visone

Ego glass doors, sides
Transparent glass

Frame
Mat lacquer visone

Back panels
Metal lacquer titanio

Led lights
Painted ardesia



L 4087 P 416 H 2299
W 161" D 16 1/2" H 90 1/2"

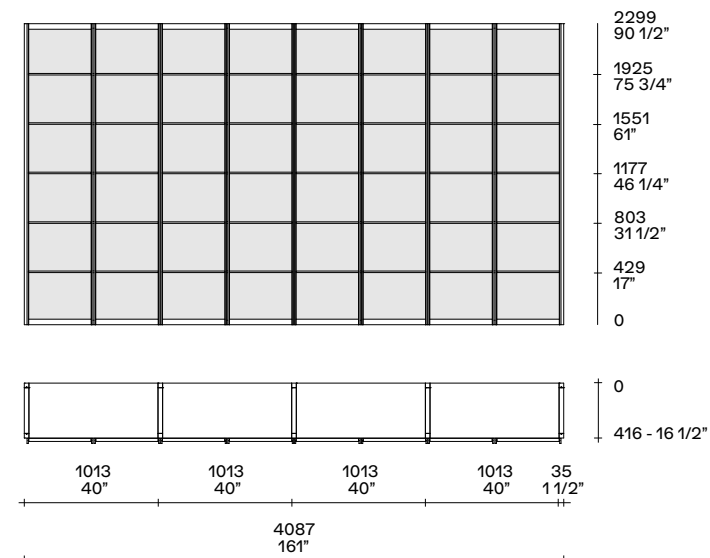

48 visone
laccato opaco
mat lacquer

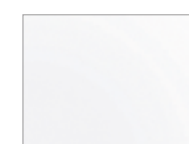

1000 vetro trasparente
transparent glass

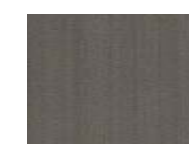

25 titanio
laccato metallico
metal lacquer

WALL SYSTEM

DATI TECNICI
TECHNICAL DATA

132

FINITURE
FINISHINGS

138

DAY SYSTEMS

133

WALL SYSTEM

Design R&D Poliform

Sistema componibile a spalle portanti e ripiani disponibile in 8 altezze, 5 larghezze e 3 profondità. Il sistema è caratterizzato dai fianchi e dai ripiani di spessore mm 35, che ne sottolineano la solidità formale e il rigore geometrico, con la possibilità di inserire delle griglie (ripiani e divisori) di spessore mm 14. Si possono creare composizioni con e senza schienale o con schienali inclinati con e senza luce.

Il sistema prevede diverse tipologie di ante in legno o in vetro, con apertura battente, scorrevole o a ribalta e cassetti in legno. Sono disponibili diverse soluzioni per la TV, vani a giorno o portali dedicati e attrezzature come gli inserti attrezzati e la scala.

Il sistema Ego Day prevede fianchi a telaio e in vetro con attrezzature specifiche.

Soluzioni speciali, tagli a misura in larghezza, altezza e profondità; fasce di tamponamento; cambi di profondità; soluzioni angolari: possibilità che confermano l'eccezionale flessibilità del sistema Wall System, in grado di adattarsi ad ogni spazio.

Fianchi, basamenti e ripiani in laccato opaco colori, laccato lucido colori e rovere spessart, schienali anche in noce gold, olmo nero e laccato metallico colori.

Parti metalliche verniciato ardesia opaco, interno cassetti nobilitato ardesia.

Modular system with bearing side panels and shelves available in 8 heights, 5 widths and 3 depths. The system is distinguished by side panels and shelves thickness 1 1/2", which underline the solidity of shapes and the geometric rigour, with the possibility of inserting grids (shelves and partitions) thickness 1/2". Compositions with and without back panel or with oblique back panels with and without light can be created.

The system provides several types of doors in wood or in glass, with leaf, sliding opening or flap doors and wooden drawers.

The system provides for several TV-unit solutions, open compartments or dedicated portals and equipment like the accessorized inserts and the ladder. The Ego Day system provides for frame sides and glass sides with specific equipment.

Special solutions, cuts on measure in width, height and depth; filler pieces; changes in depth; corner solutions; all these options confirm the exceptional versatility of the system Wall System, which is able to suit any space.

Side panels, bases and shelves in mat lacquered colours, glossy lacquered colours and spessart oak, back panels available also in gold walnut, black elm and metal lacquered colours. Metal parts mat painted ardesia, drawer interior melamine ardesia.

Per ottenere la larghezza totale, aggiungere alla somma della larghezza dei ripiani mm 35 per ogni spalla portante. Profondità mm 640 disponibile fino ad altezza mm 1177.

To obtain the total width, add to the total shelves 1 1/2" for each side panel. Depth 25 1/4" available till height 46 1/4".

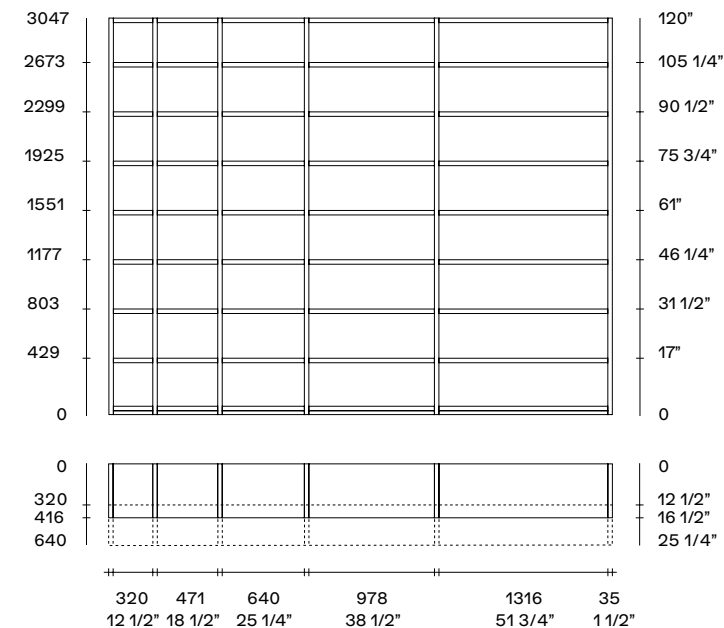

WALL SYSTEM

Design R&D Poliform

- 1 Basic anta battente
Laccato opaco colori, laccato lucido colori. Maniglie Quadro e Skin verniciato opaco ardesia.
I 471-640 h da 710 a 2206
- 2 Basic cassetti
Laccato opaco colori, laccato lucido colori. Maniglie Quadro e Skin verniciato opaco ardesia.
I 471-640-978 p 320-416-640 h 336
I 500-669 h 784-1158
- 3 Ghost anta battente a filo o sporgente
Vetro trasparente extrachiaro, trasparente riflettente, fumé, riflettente bronzato; profilo verniciato opaco ardesia. Apertura con presa laterale.
I 500-669 h 784-1158
- 4 Slim cassetti
Laccato opaco colori, laccato lucido colori, rovere spessart, olmo nero, noce gold. Apertura a pressione.
I 493-662-1000 p 320-416-640 h 361
- 5 Slim anta battente
Laccato opaco colori, laccato lucido colori, rovere spessart, olmo nero, noce gold. Vetro trasparente, fumé, satinato o lucido 6 colori, riflettente blu; profilo verniciato opaco ardesia, carbone e bianco. Apertura a pressione.
I 342-493-662-498 per vano 978
Slim vetro I 493-662 h da 735 a 1857

- 6 Slim anta a ribalta
Laccato opaco colori, laccato lucido colori, rovere spessart, olmo nero, noce gold. Apertura a pressione.
I 493-662-1000-1338 h 361
- 7 Flat cassetti
Laccato opaco colori, rovere spessart, olmo nero, noce gold. Apertura a pressione. Ripiani sagomati per cassetti
Flat anche in laccato lucido colori.
I 636-974 p 320-416 h 352
- 8 Frame anta scorrevole
Vetro trasparente, fumé; profilo verniciato opaco e lucido colori, rovere spessart, olmo nero, noce gold.
Binario sporgente laccato opaco colori, rovere spessart, olmo nero, noce gold.
I 506-675-1013-1351 h 1859
- 9 Ego Day anta battente
Vetro trasparente, trasparente riflettente, fumé, riflettente bronzato; profilo verniciato opaco ardesia e laccato opaco colori. Maniglia integrata, cerniera con apertura a 180°.
I 498-667 h 1899-2273
- 10 Scala
Laccato opaco colori. Binario sporgente laccato opaco colori, rovere spessart, olmo nero, noce gold.
I 420 h 1988

- 11 Inserti attrezzati
Laccato opaco colori, rovere spessart. Profondità mm 295 inseribile a filo struttura p 320 oppure sporgente. Profondità mm 390 inseribile a filo struttura p 416 oppure sporgente.
I 319 h 1833-2207 p 295-390
I 470 h 711-1085 p 390
I 639 h 337-711-1085 p 390
I 977-1315 h 337 p 390
- 12 Traversa ponte
Laccato opaco colori, laccato lucido colori, rovere spessart.
I 1316-1991 p 320-416 h 50
- 13 Griglie sp 14
Laccato opaco colori, laccato metallico colori. Ripiani e divisori verticali con diverse configurazioni.
I 320 solo ripiani
I da 471 a 978 h da 710 a 1832
I 1316 h 710-1084
- 14 Jet anta a ribalta e cassetto
Laccato opaco colori, laccato metallico colori, rovere spessart, olmo nero, noce gold. Ripiani sporgenti uso coperchio per ribalta e cassetti anche in laccato lucido colori, non disponibili in laccato metallico.
ribalta I 1008-1346 h 411
ribalta e cassetto I 670-1008-1346 h 251 p 320/434-416/530

- 1 Basic leaf door
Mat lacquer colours, glossy lacquer colours. Quadro and Skin handles mat painted ardesia.
w 18 1/2"-25 1/4" h from 28" to 86 3/4"
- 2 Basic drawers
Mat lacquer colours, glossy lacquer colours. Quadro and Skin handles mat painted ardesia.
w 18 1/2"-25 1/4"-38 1/2" d 12 1/2"-16 1/2"-25 1/4" h 13 1/4"
- 3 Ghost leaf door flush or jutting
Transparent extra light glass, transparent reflecting glass, fumé glass, bronzed reflecting glass; profile mat painted ardesia. Opening with side grip.
w 19 3/4"-26 1/4" h 30 3/4"-45 1/2"
- 4 Slim drawers
Mat lacquer colours, glossy lacquer colours, spessart oak, black elm, gold oak. Push-pull opening.
w 19 1/2"-26"-39 1/4" d 12 1/2"-16 1/2"-25 1/4" h 14 1/4"
- 5 Slim leaf door
Mat lacquer colours, glossy lacquer colours, spessart oak, black elm, gold walnut. Transparent glass, fumé glass, mat or glossy glass 6 colours, blu reflecting glass; profile mat painted ardesia, carbone and bianco. Push-pull opening.
w 13 1/2"-19 1/2"-26"-19 1/2" for unit 38 1/2"
Slim glass w 19 1/2"-26" h from 29" to 73"

- 6 Slim flap door
Mat lacquer colours, glossy lacquer colours, spessart oak, black elm, gold walnut. Push-pull opening.
w 19 1/2"-26"-39 1/4"-52 3/4" h 14 1/4"
- 7 Flat drawers
Mat lacquer colours, spessart oak, black elm, gold walnut. Push-pull opening. Shaped shelves for Flat drawers also available in glossy lacquer colours.
w 25"-38 1/4" d 12 1/2"-16 1/2" h 13 3/4"
- 8 Frame sliding door
Transparent glass, fumé glass; profile painted mat and glossy colours, spessart oak, black elm, gold walnut.
Jutting track mat lacquer colours, spessart oak, black elm, gold walnut.
w 20"-26 1/2"-40"-53 1/4" h 73 1/4"
- 9 Ego Day leaf door
Transparent glass, transparent reflecting glass, fumé glass, bronzed reflecting glass; profile mat painted ardesia and mat lacquer colours. Integrated handle, hinge with 180° opening.
w 19 1/2"-26 1/4" h 74 3/4"-89 1/2"
- 10 Ladder
Mat lacquer colours. Jutting track mat lacquer colours, spessart oak, black elm, gold walnut.
w 16 1/2" h 78 1/4"

- 11 Accessorized inserts
Mat lacquer colours, spessart oak. Depth 11 1/2" to be inserted flush with the structure d 12 1/2" or jutting. Depth 15 1/4" to be inserted flush with the structure d 16 1/2" or jutting.
w 12 1/2" h 72 1/4"-87" d 11 1/2"-15 1/4"
w 18 1/2" h 28"-42 3/4" d 15 1/4"
w 25 1/4" h 13 1/4"-28"-42 3/4" d 15 1/4"
w 38 1/2"-51 3/4" h 13 1/4" d 15 1/4"
- 12 Bridge bar
Mat lacquer colours, glossy lacquer colours, spessart oak.
w 51 3/4"-78 1/2" d 12 1/2"-16 1/2" h 2"
- 13 Grids th 1/2"
Mat lacquer colours, metal lacquer colours. Shelves and vertical partitions with several configurations.
w 12 1/2" only shelves
w from 18 1/2" to 38 1/2" h from 28" to 72 1/4"
w 51 3/4" h 28"-42 3/4"
- 14 Jet flap door and drawer
Mat lacquer colours, metal lacquer colours, spessart oak, black elm, gold walnut. Jutting shelves as cover for flap door and drawers also available in glossy lacquer colours, not available in metal lacquer.
flap door w 39 3/4"-53" h 16 1/4"
flap door and drawer w 26 1/2"-39 3/4"-53" h 10"
d 12 1/2"/17"-16 1/2"/20 3/4"

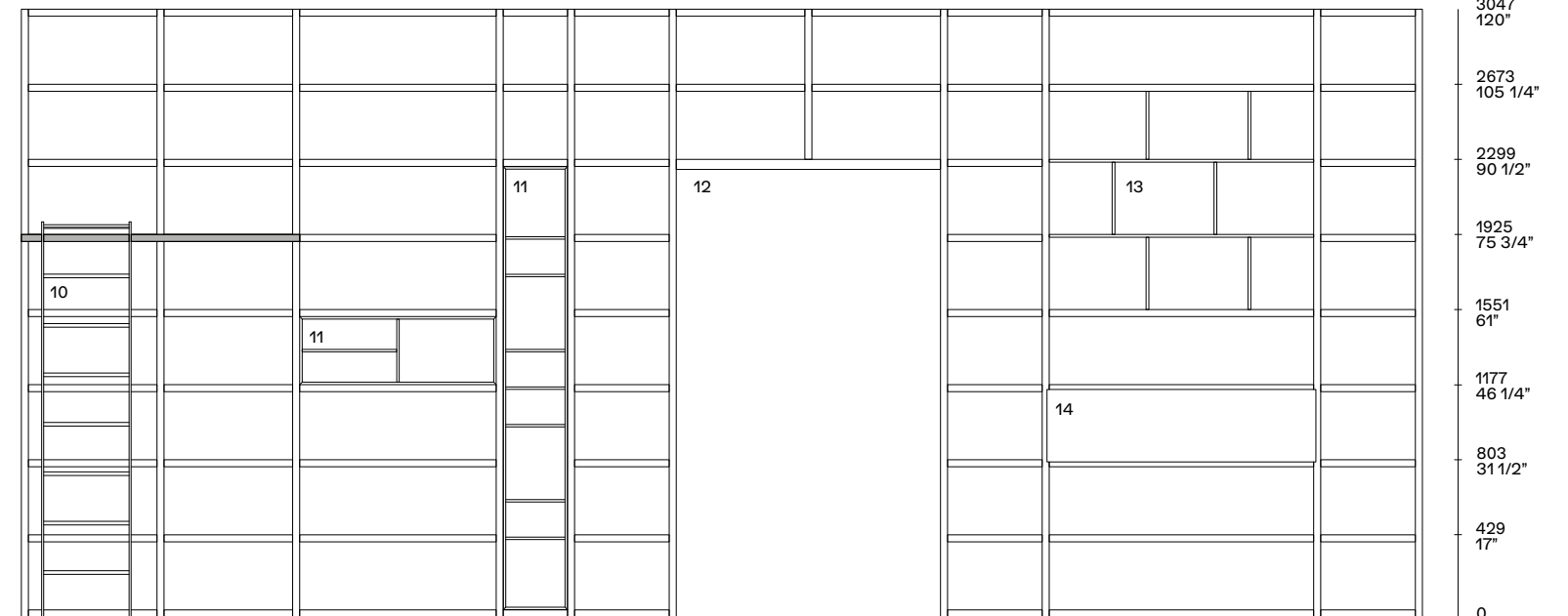
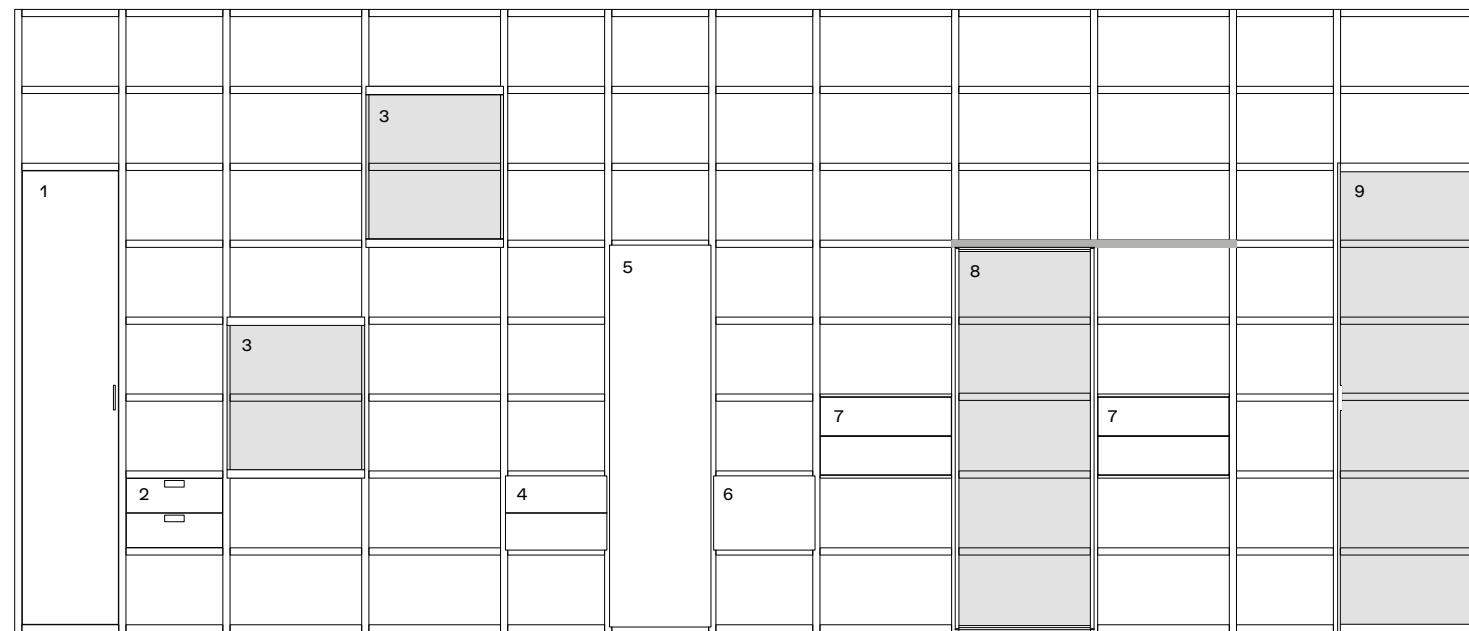

WALL SYSTEM
Design R&D Poliform

- 1 Vano TV**
Disponibili con diverse configurazioni, predisposto per passaggio cavi. Nella parte superiore ripiani fissi suddivisi da fianchetti sp 14, nella parte inferiore, a giorno con fianchetti e ripiani sp 14 o con cassette e anta a ribalta Jet. Ripiani fissi superiori e inferiori: laccato opaco colori, laccato lucido colori, rovere spessart.
Schienali: laccato opaco colori, laccato lucido colori, laccato metallico colori, rovere spessart, olmo nero, noce gold. Cassetti e anta ribalta Jet: laccato opaco colori, laccato metallico colori, rovere spessart, olmo nero, noce gold. Fianchetti e ripiani sp 14: laccato opaco colori, laccato metallico colori. I 1316-1991 p 320-416 h 1925
- 2 Fianchetti sp 14**
Laccato opaco colori, laccato metallico colori. h 339 p 254-350
- 3 Bold anta scorrevole**
Laccato opaco colori, laccato lucido colori, cuoio colori. Maniglia Bold verniciato opaco ardesia. Binario a scomparsa anodizzato alluminio, binario sporgente laccato opaco colori, rovere spessart, olmo nero, noce gold. I 506-675-1013 h 1925 per binario a scomparsa h 1860 per binario sporgente
- 4 Vano a giorno TV**
Schienale avanzato predisposto per passaggio cavi. Il vano a giorno TV può essere posizionato all'interno di colonne con ante scorrevoli Bold e Frame. Laccato opaco colori, laccato lucido colori, laccato metallico colori, rovere spessart, olmo nero, noce gold. I 1316-1991-2667 h 1087
- 5 Schienali inclinati**
Laccato metallico colori, rovere spessart, olmo nero, noce gold, gres porcellanato lucido emperador dark, calacatta oro e sahara noir. Lampade a led opzionali. I 978-1316-1991 h 339-713
- 6 Portale attrezzato per TV**
Disponibili con diverse configurazioni predisposto per passaggio cavi. Ripiano mensolone sp 60 p 530, basamento sp 35 p 416 o basamento mensolone sp 60 p 530, nella parte inferiore cassette e anta ribalta Jet e fianchetti sp 14. Ripiano mensolone e schienali: laccato opaco colori, laccato lucido colori, laccato metallico colori, rovere spessart, olmo nero, noce gold. Basamenti: laccato opaco colori, laccato lucido colori, rovere spessart, olmo nero, noce gold. Cassetti e anta ribalta Jet: laccato opaco colori, laccato metallico colori, rovere spessart, olmo nero, noce gold.

- Fianchetti sp 14: laccato opaco colori, laccato metallico colori. Portale TV I 1991-2667 h 1925 Portale a giorno con ripiani mensolone sp 60 p 530 inferiore e superiore, I 1991-2667, schienali h 663-1037
- 7 Portale attrezzato con scrittoio**
Disponibili con diverse configurazioni, predisposto per passaggio cavi. Ripiani mensolone sp 60 p 530, basamento sp 35 p 416, cassetto Jet e fianchetti sp 14. Piano scrittoio con due prese elettriche e due prese USB. Ripiano mensolone e schienali: laccato opaco colori, laccato lucido colori, laccato metallico colori, rovere spessart, olmo nero, noce gold. Basamento: laccato opaco colori, laccato lucido colori, rovere spessart, olmo nero, noce gold. Piano scrittoio: cuoio colori, rovere spessart, olmo nero, noce gold. Cassetto Jet: laccato opaco colori, laccato metallico colori, rovere spessart, olmo nero, noce gold. Fianchetti sp 14: laccato opaco colori, laccato metallico colori. Portale I 1991-2667 h 1925 Piano scrittoio I 1400 p 540 I 1600 p 640

- 1 TV-unit**
Available with several configurations, arranged for cable passage. In the upper part, fixed shelves separated by side panels th 1/2", in the lower part, open compartment with side panels and shelves th 1/2" or with drawers and Jet flap door. Upper and lower fixed shelves: mat lacquer colours, glossy lacquer colours, spessart oak. Back panels: mat lacquer colours, glossy lacquer colours, metal lacquer colours, spessart oak, black elm, gold walnut. Drawers and flap door Jet: mat lacquer colours, metal lacquer colours, spessart oak, black elm, gold walnut. Side panels and shelves th 1/2": mat lacquer colours, metal lacquer colours. w 51 3/4"-78 1/2" d 12 1/2"-16 1/2" h 75 3/4"
- 2 Side panels th 1/2"**
Mat lacquer colours, metal lacquer colours. h 13 1/4" d 10"-13 3/4"
- 3 Bold sliding door**
Mat lacquer colours, glossy lacquer colours, hide colours. Handle Bold mat painted ardesia. Concealed track anodized aluminium, jutting track mat lacquer colours, spessart oak, black elm, gold walnut. w 20"-26 1/2"-40" h 75 3/4" for concealed track h 73 1/4" for jutting track

- 4 Open TV-unit**
Advanced back panel arranged for cable passage. The open TV-unit can be placed inside units with sliding doors Bold and Frame. Mat lacquer colours, glossy lacquer colours, metal lacquer colours, spessart oak, black elm, gold walnut. w 51 3/4"-78 1/2"-105" h 42 3/4"
- 5 Oblique back panels**
Metal lacquer colours, spessart oak, black elm, gold walnut, glossy gres porcelain emperador dark, calacatta oro and sahara noir. Optional led light. w 38 1/2"-51 3/4"-78 1/2" h 13 1/4"-28"
- 6 Accessorized portal with TV-unit**
Available in several configurations, arranged for cable passage. Thick shelf th 2 1/4" d 20 3/4", base th 1 1/2" d 16 1/2" or thick base th 2 1/4" d 20 3/4", in the lower part drawers and flap door Jet and side panels th 1/2". Thick shelf and back panels: mat lacquer colours, glossy lacquer colours, metal lacquer colours, spessart oak, black elm, gold walnut. Bases: mat lacquer colours, glossy lacquer colours, spessart oak, black elm, gold walnut. Drawers and flap door Jet: mat lacquer colours, metal lacquer colours, spessart oak, black elm, gold walnut.

- Side panels th 1/2": mat lacquer colours, metal lacquer colours. TV-portal w 78 1/2"-105" h 75 3/4" Open portal with thick shelves th 2 1/4" d 20 3/4" lower and upper, w 78 1/2"-105", back panels h 26"-40 3/4"
- 7 Accessorized portal with writing desk**
Available in several configurations, arranged for cable passage. Thick shelves th 2 1/4" d 20 3/4", base th 1 1/2" d 16 1/2", Jet drawer and side panels th 1/2". Desktop with two electrical outlets and two USB outlets. Thick shelf and back panels: mat lacquer colours, glossy lacquer colours, metal lacquer colours, spessart oak, black elm, gold walnut. Base: mat lacquer colours, glossy lacquer colours, spessart oak, black elm, gold walnut. Desktop: hide colours, spessart oak, black elm, gold walnut. Jet drawer: mat lacquer colours, metal lacquer colours, spessart oak, black elm, gold walnut. Side panels th 1/2": mat lacquer colours, metal lacquer colours. Portal w 78 1/2"-105" h 75 3/4" Desktop w 55" d 21 1/4" w 63" d 25 1/4"

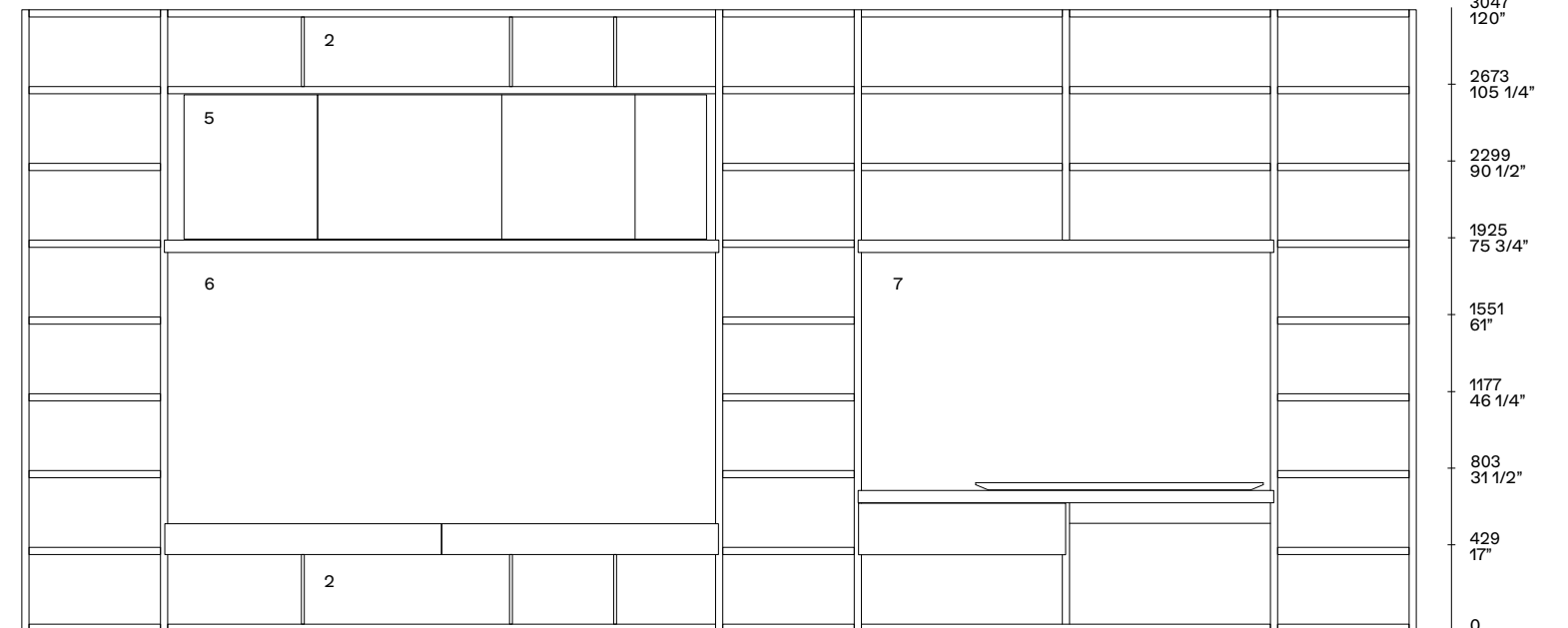
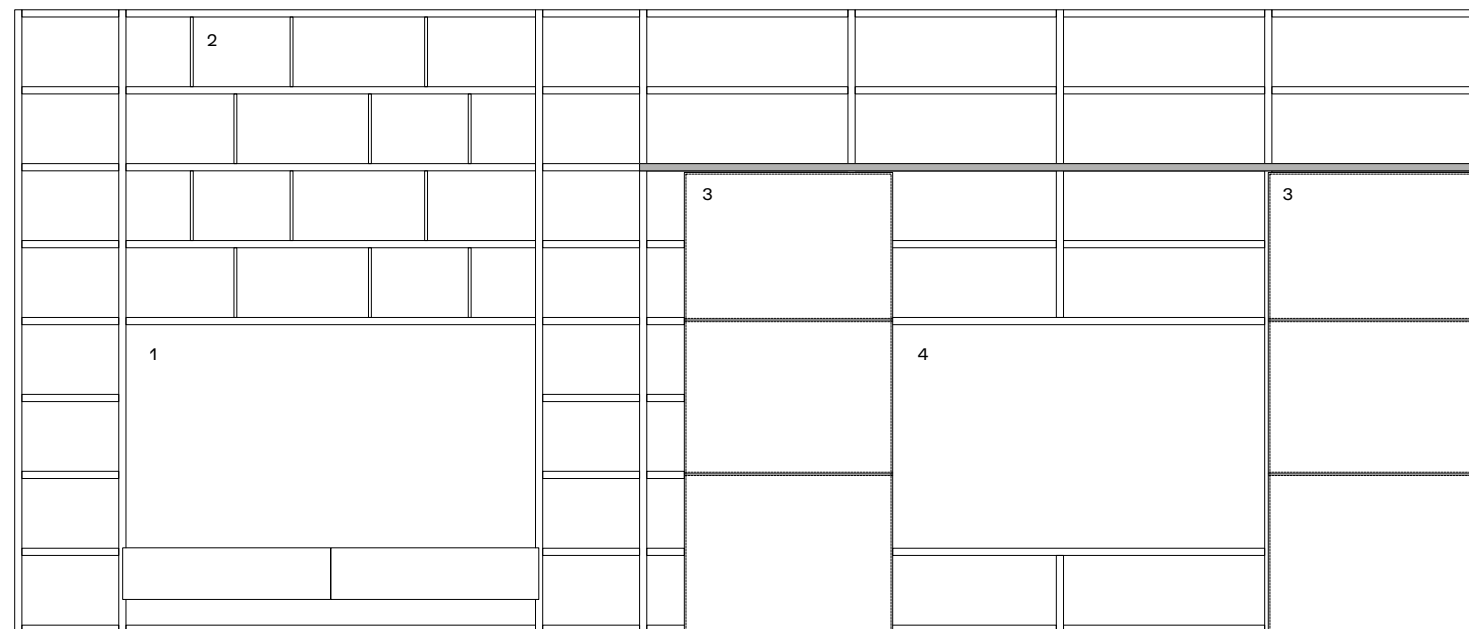

FINITURE WALL SYSTEM
WALL SYSTEM FINISHINGS

Laccato opaco
Mat lacquer



Laccato lucido
Glossy lacquer

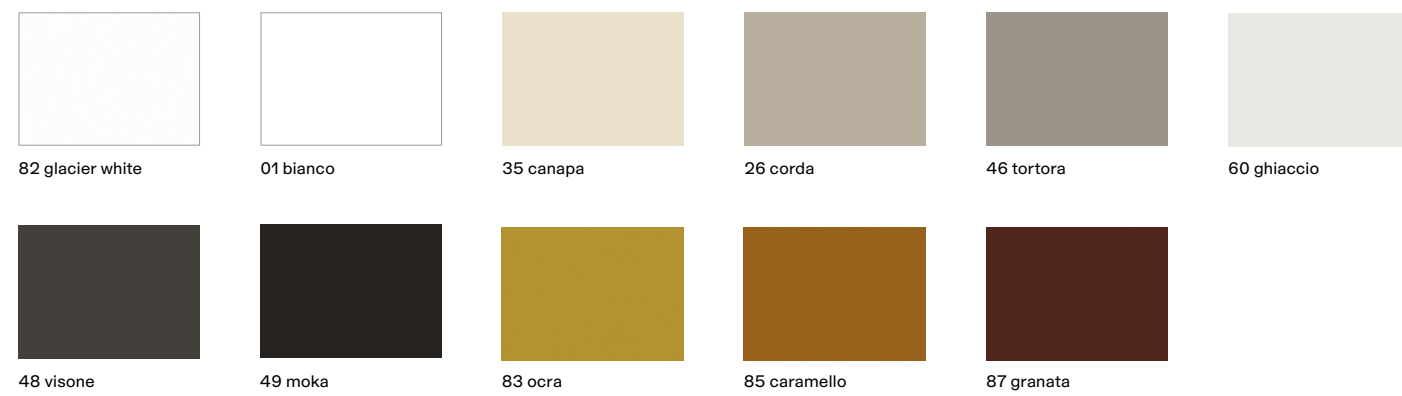

Laccato metallico
Metallic lacquer



Essenza
Wood

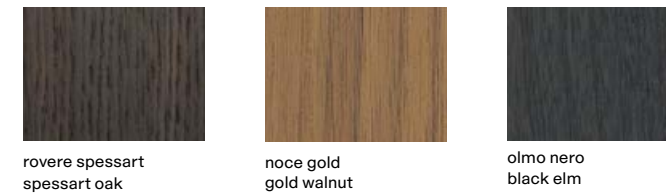

Gres porcellanato lucido
Glossy gres porcelaine



Parti metalliche
Metal parts



Nobilitato
Melamine

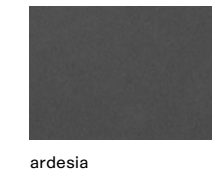

Vetro
Glass

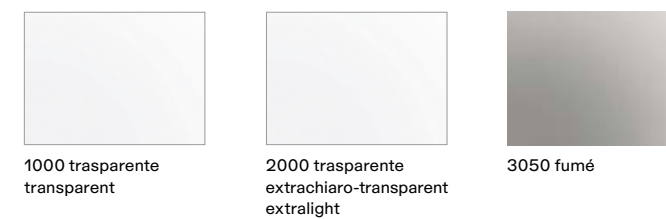

Vetro riflettente
Reflecting glass

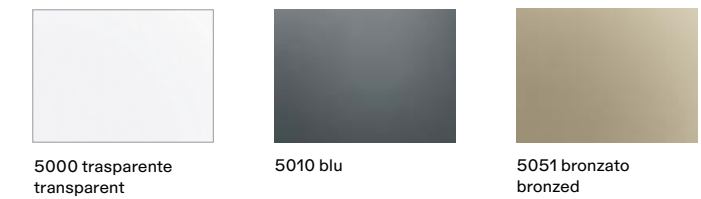

Vetro satinato e lucido
Mat and glossy glass

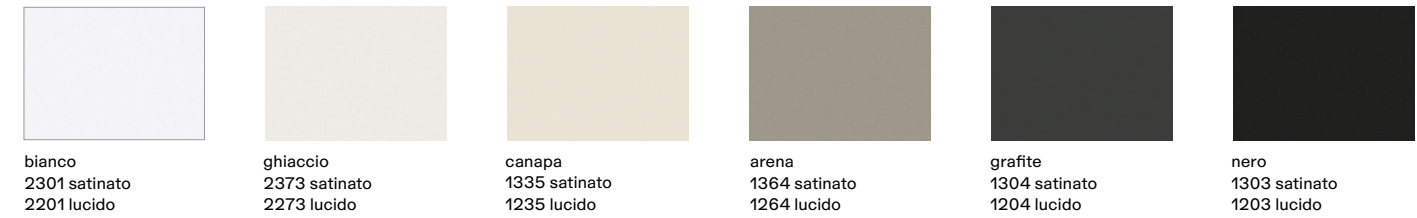

Cuoio
Hide

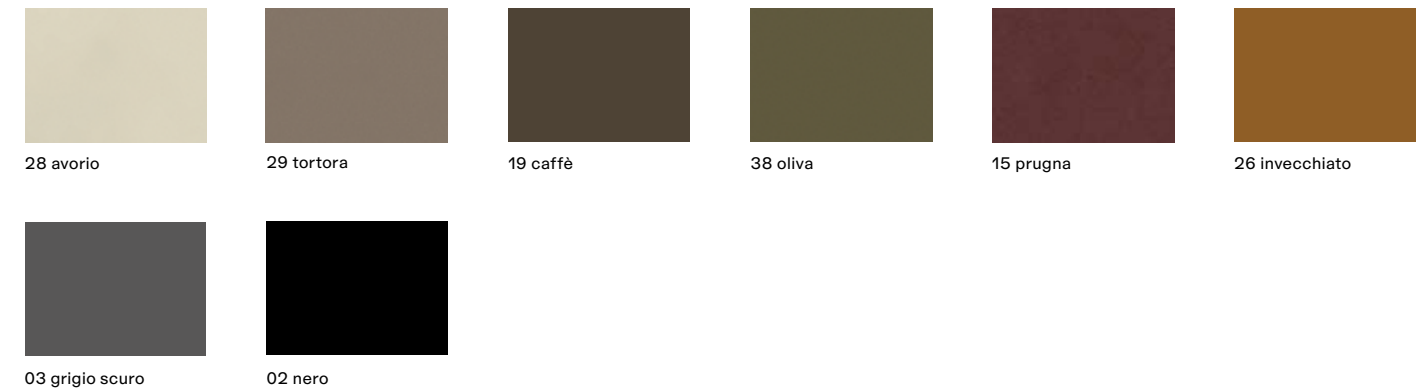

Poliform Spa

via Montesanto 28
Casella postale n. 1
22044 Inverigo (CO) Italy
t +39 031 6951
f +39 031 699444
info@poliform.it
poliform.it

Poliform realizza tutte le sue collezioni in Italia usando componenti e materie prime selezionate.

All the Poliform collections are manufactured 100% in Italy using top-class components and materials.

Poliform si riserva il diritto di apportare, senza preavviso, ogni modifica mirata al miglioramento funzionale e qualitativo dei propri prodotti. Testi e disegni presenti in questo stampato hanno scopo divulgativo; per ogni aspetto tecnico e dimensionale fare riferimento ai listini aziendali e relativi aggiornamenti. I campioni di colori e materiali hanno valore indicativo.

Poliform reserves the rights at all time to apply modifications for the functional or qualitative improvement of its products. Texts and drawings present in this brochure have a divulgative purpose; for every technical and dimensional aspect please refer to the company's price lists and their relative updatings. The colour and material samples have an indicative value.



2018 Adi Compasso D'oro
Career Award