



## 介绍

床头柜

胶合刨花板

镶贴、漆面或大理石刨花板

漆面压铸铝，高度可调节的支脚

带校平器或墙壁悬挂装置的涂漆铝

## 尺寸

### 501

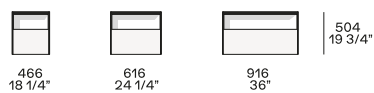
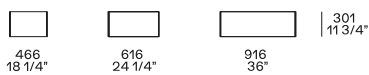

带抽屉

Con cassetto e vano giorno

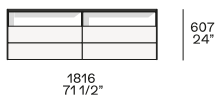

Con cassetti e vani a giorno

### 501

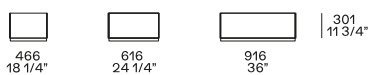

Con cassetto

Con cassetto aperto

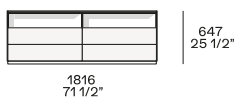

Con cassetto aperto